

ACCESSORY FOR
LAWN TRACTOR

ATM40



ALNOVA[®]

Millasur, SL.
Rúa Eduardo Pondal, nº 23 - Pol. Ind. Sigüeiro
15688 - Oroso - A Coruña - 981 696 465 www.millasur.com



ANOVA wishes to congratulate you for choosing one of our products and guarantees the assistance and cooperation that has always distinguished our brand over time.

This machine is designed to last for many years and to be very useful if used in accordance with the instructions contained in the user manual. We therefore recommend that you read this instruction manual carefully and follow all our recommendations.

For more information or questions, you can contact us through our web supports such as www.anova.es and www.millasur.com

INFORMATION ABOUT THIS MANUAL

Pay attention to the information provided in this manual and on the machine for your safety and that of others.

- This manual contains instructions for use and maintenance.
- Take this manual with you when you go to work with the machine.
- Contents are correct at time of printing.
- The rights to make alterations are reserved at any time without affecting our legal responsibilities.
- This manual is considered an integral part of the product and should remain with it in the event of loan or resale.
- Ask your dealer for a new manual in case of loss or damage.

READ THIS MANUAL CAREFULLY BEFORE USING THE MACHINE

To ensure that your machine provides the best results, please read the usage and safety guidelines carefully before using it.

OTHER WARNINGS:

Incorrect use could cause damage to the machine or other objects.

Adapting the machine to new technical requirements could cause differences between the content of this manual and the product purchased.

Read and follow all instructions in this manual. Failure to follow these instructions could result in serious personal injury.

■ Content

1. Safety warnings and general rules
2. Components and parts of the ATM40 accessory
3. Assembly instructions
4. Operation
5. Maintenance and storage
6. Environment
7. Exploded view
8. CE conformity declaration

1. Safety warnings and general rules

Please read this manual carefully before using the riding mower attachment.

The operator must read and understand all safety and warning information, start-up instructions, maintenance and storage instructions before using this equipment. Failure to properly use and maintain this product could result in serious injury to the operator and bystanders.

Operation warnings

- Be careful at all times when using electrical equipment.
- Please read this owner's manual carefully for operating and service instructions before attempting to assemble or operate this equipment. Become completely familiar with the proper use of this equipment.
- Read the vehicle owner's manual and vehicle safety rules, and know how to operate the vehicle before using this accessory.
- Never allow children to use the tractor or attachment to remove straw, and do not allow adults to operate it without proper instructions.
- This straw removal accessory has sharp points. Always handle with care and wear substantial footwear when operating this accessory.
- Do not allow anyone to climb or sit on the straw removal attachment or on a tow vehicle.
- Keep the operating area free of people, especially small children and also pets.
- Always start with the transmission in first (low) gear and the engine in low gear, gradually increasing speed as conditions allow.
- Braking and vehicle stability may be affected by the installation of this equipment. Be on the lookout for changing conditions on slopes. Consult the safety rules in your vehicle owner's manual for safe operation on slopes.
- Stay off steep slopes.
- Operate up and down a slope, never across the face of a slope.
- This equipment should be operated at reduced speed in rough terrain, along streams and ditches, and on slopes, to avoid tipping and loss of control. Don't drive too close to a stream or ditch.
- Do not tow this equipment on a highway or any other public highway.
- Follow the maintenance instructions outlined in this owner's manual.

Cutting and crushing hazards

- Always keep hands and feet away from moving parts while using the equipment.
- Always clear and keep work area clean during use.
- Always wear safety equipment, eye protection, suitable clothing, gloves and work boots when using the equipment.







The warnings, cautions, and instructions described in this instruction manual cannot cover all possible conditions or situations that may occur. Common sense and caution are factors that must be present at all times.

Assembly required

This product requires assembly before use. See the mounting instructions section for more information.

Definitions of Hazard Signal Words

	This is the safety alert symbol. It is used to alert you to potential personal injury hazards. Obey all safety messages that follow this symbol to avoid possible injury or death.
 DANGER	Danger - Indicates an imminently hazardous situation which, if not avoided, will result in death or serious injury.
 WARNING	Warning: Indicates a potentially hazardous situation which, if not avoided, could result in death or serious injury.
 CAUTION	Caution: Indicates a potentially hazardous situation which, if not avoided, may result in minor or moderate injury.
CAUTION	Caution: Without the safety alert symbol indicates a potentially dangerous situation which, if not avoided, could result in property damage.

2. Components and parts of the ATM40 accessory

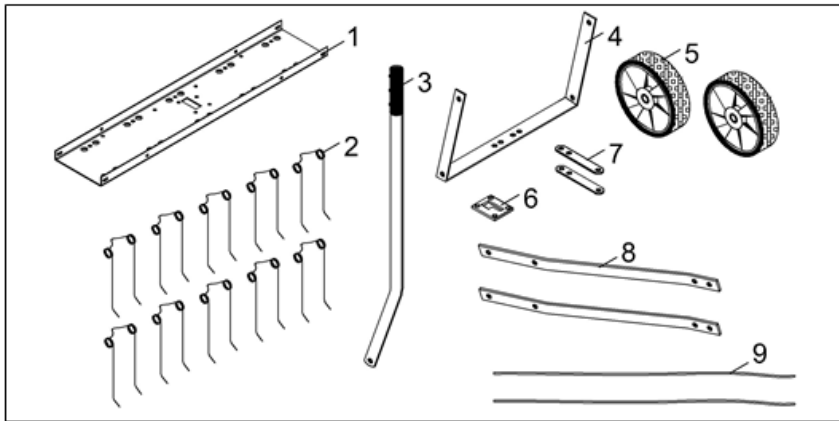

Part	Description
1	Comb base
2	Spring tines
3	Height adjustment lever
4	Shaft support
5	Wheels
6	Lifting plate
7	Hitch brackets
8	Hitch mount
9	Spring alignment

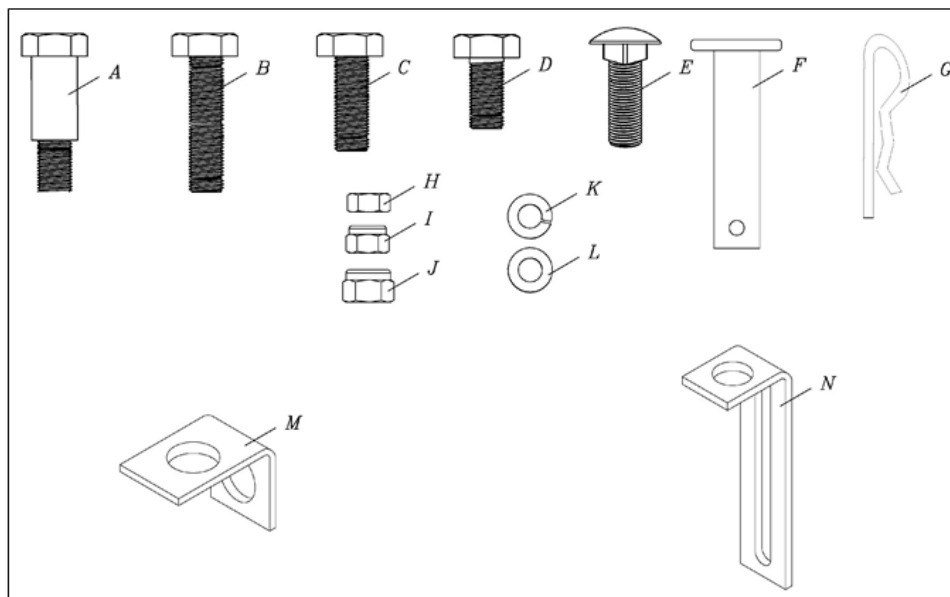

Part	Quantity	Description
TO	2	Stop bolt
B	2	Hexagon bolt M8x50
C	2	Hexagon bolt M8x30
D	fifteen	Hexagon bolt M8x20
AND	14	Carriage bolt M8x25
F	1	Hitch pin \varnothing 10
G	1	Cotter pin \varnothing 3
H	14	Hex nut M8
I	19	Hex nut M8
J	2	Hex nut M10
K	14	Lock washer \varnothing 8
L	10	Large flat washer \varnothing 8
M	4	Angle bracket
N	3	Hitch arm mounting brackets

3. Assembly instructions

Tools required for assembly:

- (2) 1/2 "wrenches
- (1) 9/16 "wrench
- (1) 3/4 "wrench or adjustable wrench
- (1) Pliers

Before assembling the accessory, set up all parts and hardware as shown on the previous pages.

The 40 "straw eliminator is shown in the following drawings. The 40" and 48 "assembly is the same except as indicated in the instructions.

1. Mount the lift plate on top of the tine guard with four M8x20 hex bolts and M8 hex locknuts as shown in the figure. Squeeze in.

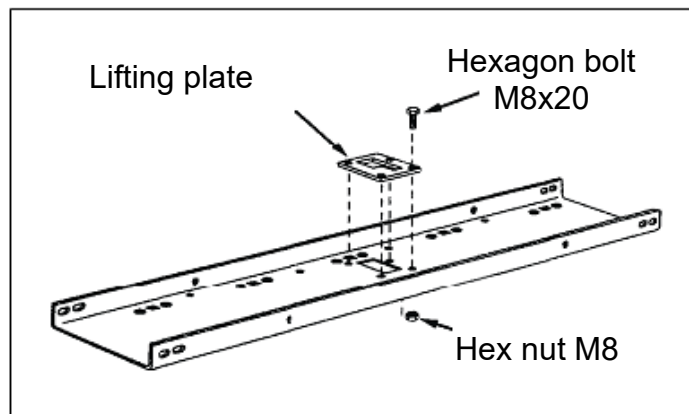

2. Flip the tine guard over.
3. Mount two hitch arm mounting brackets (tall) and two angle brackets (short) to the bottom of the tine guard. Attach the brackets to the four round holes in the back of the tine guard with four M8x20 hex bolts and M8 hex locknuts. Do not tighten yet.
4. Mount two angle brackets in the round holes in the bottom of the tine guard at the front. Use two M8x20 hex bolts and M8 hex locknuts. Do not tighten yet.

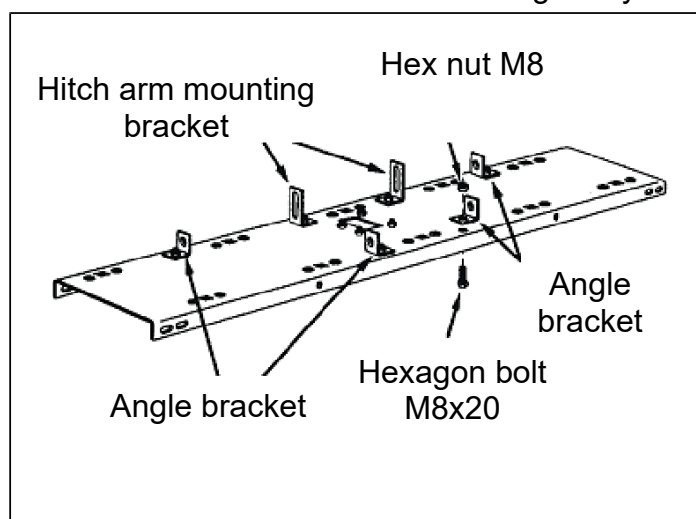

- 5.
6. Attach the hitch mounting arms to the outside of the angle brackets on the front of the tine guard. Use two M8x20 hex bolts and M8 hex locknuts. Tighten and then loosen the nuts slightly.

7. Attach the hitch mounting arms to the outside of the hitch arm mounting brackets on the rear of the tine guard. Use two M8x25 carriage bolts, Ø8 lock washers and M8 hex nuts. Do not tighten yet.

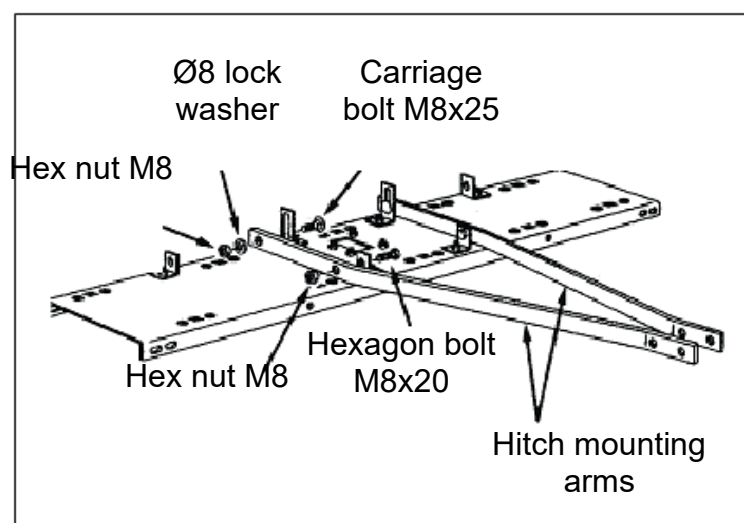

8. Assemble the front ends of the hitch mounting arms with two M8x30 hex bolts and M8 hex locknuts. Do not tighten yet.
9. Mount the hitch brackets to the top and bottom of the hitch mounting arms with two M8x50 hex bolts and M8 hex locknuts. Do not tighten yet.
10. Assemble the $\Phi 10$ hitch pin through the hitch brackets and secure with a 3 clevis pin.

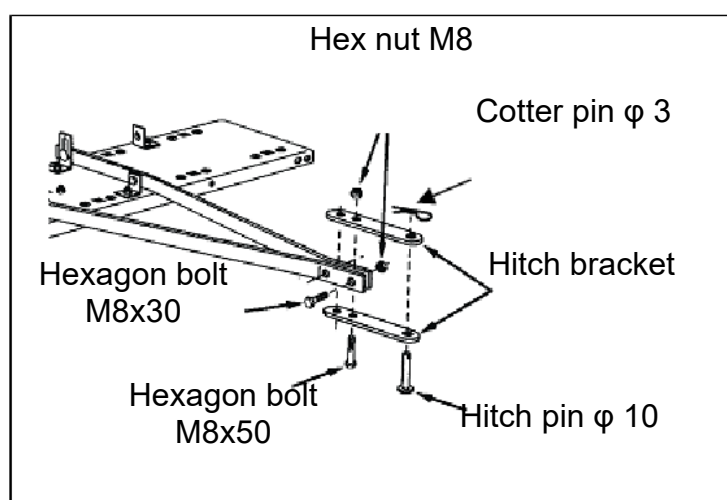

11. Tighten the bolts and nuts assembled at point 8.
- Tighten the bolts and nuts assembled in point 7.
- Tighten the bolts and nuts assembled in point 3.
- Tighten the bolts and nuts assembled in point 4.
- Tighten then slightly loosen the bolts and nuts assembled in point 5.
- Tighten the bolts and nuts assembled in point 6.
11. Mount the axle bracket to the outside of the angle brackets with two M8x20 hex bolts and M8 hex locknuts. The ends of the axle bracket should point as shown in figure 5. Tighten then slightly loosen the bolts and nuts.

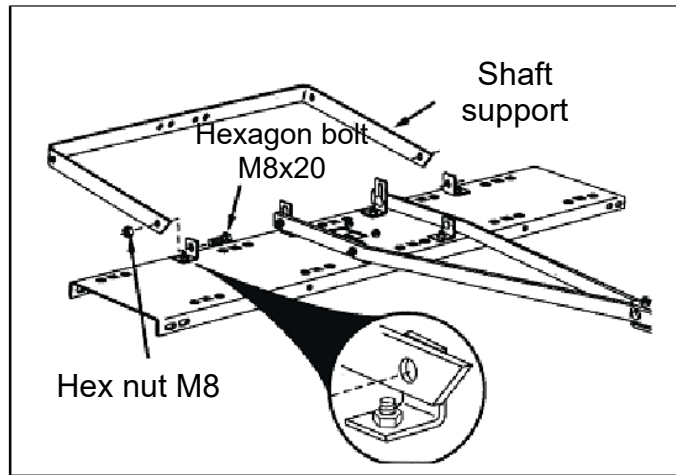

12. Mount the wheels to the axle bracket with two flange bolts and two M10 hex locknuts. To tight.

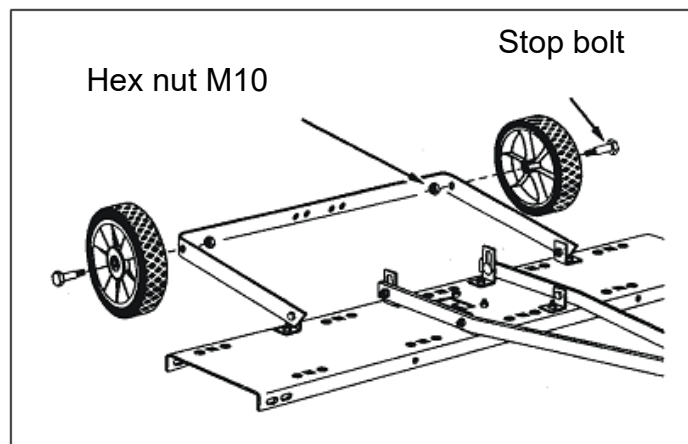

13. Attach ten spring teeth to the square holes at the bottom of the tooth guard. Use an M8x25 carriage bolt, a $\Phi 8$ large flat washer, an $\Phi 8$ lockwasher, and an M8 hex nut for each spring tooth. To tight. Note: The spring prongs must seat between the dimples.

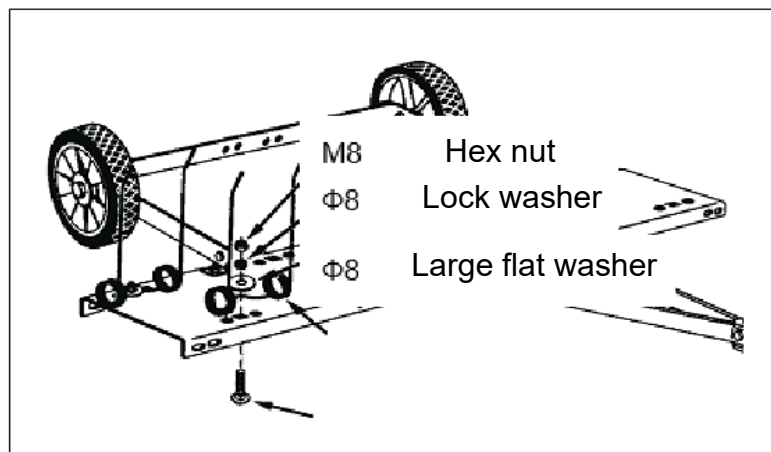

14. Assemble the spring alignment cables through the front and rear rows of spring barbs, passing the cables between the hitch mounting arms and the barb guard. Bend the ends of the cables to secure them.

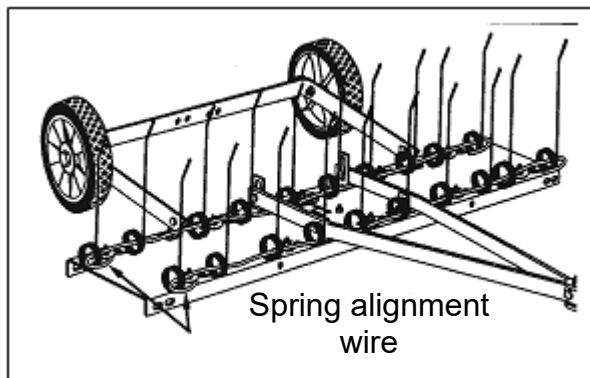

15. Mount a hitch arm mounting bracket to the axle bracket using two M8x25 carriage bolts, Ø 8 lock washers, and M8 hex nuts. Do not tighten yet.
16. Insert the lift handle down through the tine guard. Attach to the newly assembled hitch arm mounting bracket with an M8x20 hex bolt and M8 hex locknut. To tight.
17. Position the hitch arm mounting bracket so that there is lateral tension on the lift handle when it is locked in the up position. Tighten the nuts.

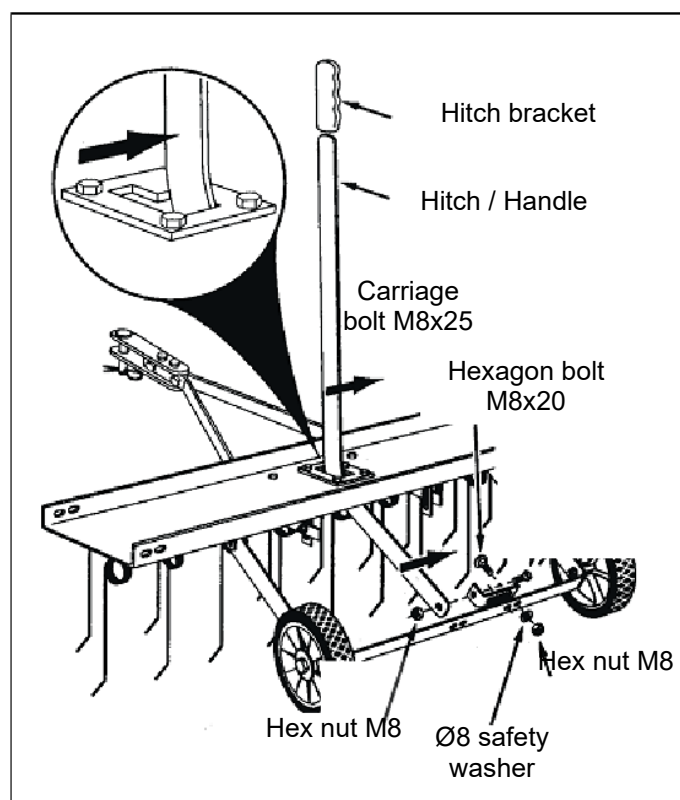

4. Operation

Regular removal of thatch is critical to maintaining a healthy lawn. Straw is a layer of stems, clippings, stalks, roots, and leaves that have not decomposed. Excess straw prevents air, water, and fertilizer from reaching the roots. The thatch remover effectively dislodges excess thatch from your lawn. Read these instructions to help prevent improper adjustment and operation. Proper adjustment of the tine guard and spring tines is important for effective performance. See the following steps to make the proper adjustment before operating the stripper.

1. Move the tow vehicle to a level surface, such as a driveway or garage floor, and attach the tine thatch remover to the vehicle hitch.
2. To adjust the spring tine guard:

- Lower the blade remover to the operating position using the lift handle.
- Loosen the two hex nuts and carriage bolts that secure the rear of the hitch mounting arm to the hitch arm mounting brackets.
- Adjust the tin guard until it is level and the front and rear spring teeth are in contact with the ground.
- Retighten the hex nuts.

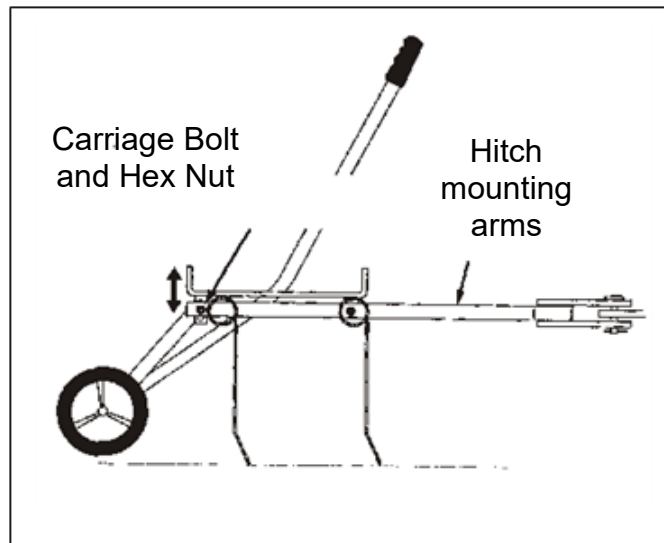

3. Vary vehicle forward speed until best clearing action is achieved.
4. For best results, use a crisscross pattern on your lawn.
5. If the straw remover appears to be "jumping" during use, then additional weight should be added to the tine guard. In most conditions, additional weight will be required.

The weight of patio concrete blocks is recommended due to their low profile; however, any type of weight is adequate if it can be attached to the shield.

Secure the weight using suitable binding material, such as rubber straps or wire, attaching it to the holes in the shield flange.

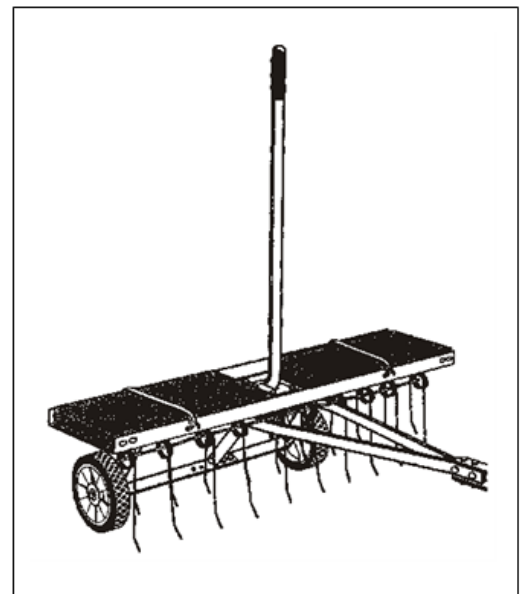

5. Maintenance and storage



Improper maintenance and storage can void your warranty.

Maintenance

1. Before each use, check that all nuts and bolts are tight.
2. Lubricate the wheels as necessary.
3. If rust appears on guard or spring teeth, lightly sand and coat with enamel paint.
4. Always store in a dry area and coat exposed metal with light oil when not in use.



If a part needs to be replaced, use only parts that meet the manufacturer's specifications. Replacement parts that do not meet specifications can result in a safety hazard or poor performance.

Note: To remove the wheel, use a screwdriver to remove the hub cap, remove the locknut and washer.

Storage

- Never allow material to remain in the hopper for long periods of time.
- Before storing, make sure the spreader is clean and dry for years of trouble-free service.
- Store indoors or in a sheltered area during severe weather and winter months.



Always maintain proper tire pressure. Do not over or under inflate the tires, as serious injury may result. Always keep the tires at 25 PSI.

6. Environment



Protect the environment. Recycle the oil used by this machine by taking it to a recycling center. Do not pour used oil into drains, land, rivers, lakes or seas.



Dispose of your machine in an environmentally friendly way. We must not dispose of machines together with household garbage. Its plastic and metal components can be classified according to their nature and recycled.

The materials used to pack this machine are recyclable. Please do not dispose of the packaging in the household waste. Dispose of these packages at an official waste collection point.

7. Exploded view

ALNOVA
ATM4

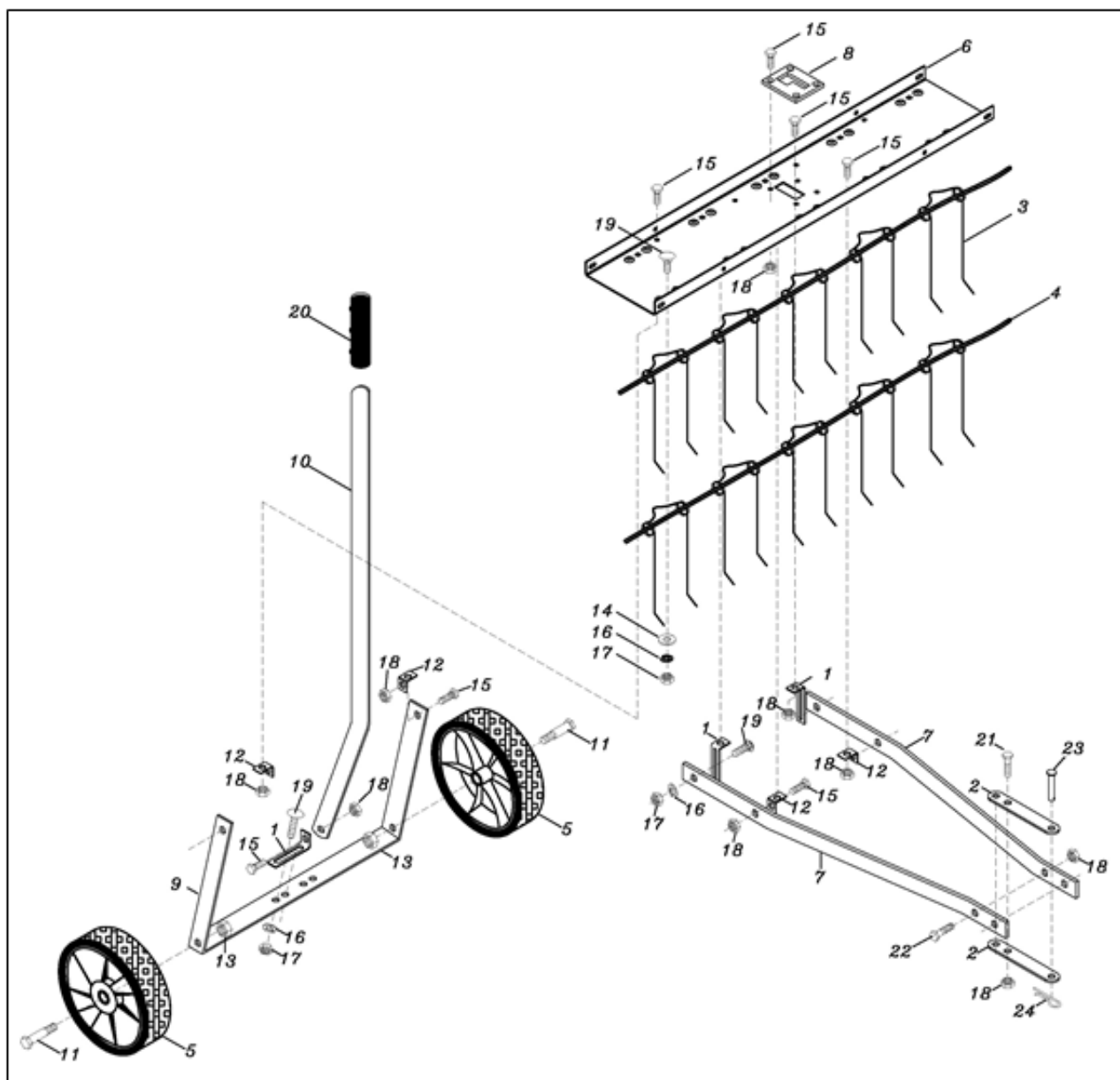

8. CE conformity declaration

DISTRIBUTION COMPANY

MILLASUR, SL
RUA EDUARDO PONDAL, Nº 23 PISIGÜEIRO
15688 OROSO - A CORUÑA
SPAIN



ALNOVA

CE DECLARATION OF CONFORMITY

In compliance with the different CE directives, it is hereby confirmed that, due to its design and construction, and according to the CE mark printed by the manufacturer on it, the machine identified in this document complies with the relevant and fundamental requirements in health and safety. of the aforementioned CE directives. This declaration validates the product to display the CE symbol.

In the event that the machine is modified and this modification is not approved by the manufacturer and communicated to the distributor, this declaration will lose its value and validity.

Machine name: **LAWN TRACTOR ATTACHMENT**

Model: ATM40

Recognized and approved standard to which it conforms:

directive 2006/42 / EC

Tested according to the standards:

**EN ISO 12100: 2010
EN 349: 1993 + A1: 2008
EN 953: 1997 + A1: 2009
EN ISO 13857: 2008**

Company seal

MILLASUR, S.L.U.

Rúa Eduardo Pondal, 23 - Pol. Emp. Sigüeiro
15688-Oroso-A Coruña

Tel.(+34) 981 69 64 65 - Fax (+34) 981 69 08 61

e-mail: millasur@millasur.com

CIF: B15 749 922

04/07/2016