

Instructions and user manual

MG3514



ALNOVA[®]

Millasur, SL.
Rúa Eduardo Pondal, nº 23 - Pol. Ind. Sigüeiro
15688 - Oroso - A Coruña 981 696465 www.millasur.com

EN



ANOVA wishes to congratulate you for choosing one of our products and guarantees the assistance and cooperation that has always distinguished our brand over time.

This machine is designed to last for many years and to be of great use if used in accordance with the instructions contained in the user manual. We therefore recommend that you read this instruction manual carefully and follow all our recommendations.

For more information or doubts, you can contact us through our web supports such as www.anovamaquinaria.com.

INFORMATION ABOUT THIS MANUAL

Pay attention to the information provided in this manual and on the machine for your safety and that of others.

- This manual contains instructions for use and maintenance.
- Take this manual with you when you go to work with the machine.
- The contents are correct at the time of printing.
- The rights to make changes at any time are reserved without affecting our legal responsibilities.
- This manual is considered an integral part of the product and must remain with it in case of loan or resale.
- Ask your dealer for a new manual in case of loss or damage.

READ THIS MANUAL CAREFULLY BEFORE USING THE MACHINE

To ensure that your machine provides the best results, please read the usage and safety regulations carefully before using it.

OTHER WARNINGS:

Incorrect use could cause damage to the machine or other objects.

The adaptation of the machine to new technical requirements could cause differences between the content of this manual and the purchased product.

Read and follow all instructions in this manual. Failure to follow these instructions could result in serious personal injury.

INDEX

1. TECHNICAL SPECIFICATIONS
2. BASIC SAFETY INDICATIONS
3. SYMBOLS ON THE MACHINE
4. MACHINE PARTS
5. BAR AND CHAIN ASSEMBLY
6. FUEL AND OIL FOR THE CHAIN
7. BEFORE YOU START TO USE
8. USE AND PRECAUTIONS
9. FUNCTIONING
10. MAINTENANCE
11. PROBLEM SOLVING
12. STORAGE
13. WARRANTY
14. ENVIRONMENT
15. EXPLODED
16. CE CERTIFICATION





1. TECHNICAL SPECIFICATIONS

MODEL	MG3514
DIMENSIONS (mm)	420x235x280
MAX POWER (kw)	1.2
DISPLACEMENT (cm ³)	35.2
IDLE SPEED (rpm)	3300 ±400
MAXIMUM REVOLUTIONS (rpm)	12500
WEIGHT (kg)	4.6
FUEL	2T gasoline mix 40:1
DEPOSIT CAPACITY	320
CONSUMPTION (MAXIMUM POWER)	600g/kw.h
LUBRICATION OIL	SAE10W-30
LUBRICATION OIL CAPACITY (ml)	200
CARBURETOR	Walbro WT1128 Diaphragm
SPARK PLUG	NGK BPMR7A
SWORD	Rolled 14" 120SDEA041
STRING	3/8" .050" 91P045X

ANOVA®

2. BASIC SAFETY INDICATIONS

 ***Please read the instructions provided to you carefully and make sure you understand the content. Familiarize yourself with the chainsaw and the control of all its elements by reading the manual.***

 ***Be sure to keep this manual handy so you can refer to it later whenever questions arise. Be sure to include this manual when you sell, lend, or otherwise transfer ownership of this product.***

 ***Never remodel the product by yourself as you may lose the warranty of the machine.***



DANGER OR WARNING



DANGER. BE CAREFUL OF THE BOUNCE



AVOID CONTACT WITH THE CUTTER BAR



ON MACHINES WITH FRONT BAR PROTECTION, BOUNCE IS PREVENTED.



READ THE MACHINE INSTRUCTIONS



EQUIP PROTECTION ELEMENTS AND VISUAL PROTECTION



DO NOT USE WITH ONE HAND



HOLD THE MACHINE FIRMLY WITH BOTH HANDS.



DIAGONAL LINE OVER ANY SYMBOL INDICATES "PROHIBITED" OR "AVOID".

- Wear safety shoes, tight-fitting clothing, protective gloves, and eye, hearing, and head protection devices.
- Do not allow other people to be near when starting or working on the chainsaw. Keep other people and animals out of the work area.
- Do not start cutting until you have a clear work area, secure footing, and a planned fall tree retreat path. Also, plan your work and ensure a work area free of obstacles and, in the case of felling, at least one escape route from the falling tree.
- Keep all parts of your body away from the saw chain when the engine is running.
- Before starting the engine, make sure the saw chain is not in contact with anything.

- Do not use a chain that is damaged, poorly adjusted, or not fully and securely mounted. Make sure the chain stops moving when the throttle control trigger is released.
- Shut off the engine before adjusting the chain saw. Before refueling, repairing, or transporting the chain saw, turn off the engine.

- Keep handles dry, clean and free of oil or fuel mixture.



- Use the chain saw only in well-ventilated areas. Do not run the engine indoors. Exhaust gases contain harmful carbon monoxide.

- Protect yourself against kickback. Kickback can lead to dangerous loss of control of the chain saw.
- Metal parts reach high temperatures immediately after stopping the engine.



- Never use the machine...

1. When the floor is slippery or when other conditions exist that might make it impossible to maintain a stable posture.

2. At night, in times of heavy fog, or any other time your field of vision may be limited. During rain storms, during lightning storms, at times of high winds, or any other time weather conditions may make it unsafe to use this product.

3. With a damaged or poorly adjusted chain or that is not completely and securely assembled. Make sure the saw chain stops moving when the throttle control trigger is released. Never adjust the guide bar or saw chain when the engine is running.





4. Under the influence of alcohol, when you are exhausted/deprived of sleep, when you are drowsy as a result of taking medication, or at any other time when your judgment may be impaired.

Lack of sleep, tiredness or physical exhaustion results in a lower level of attention, and this in turn leads to accidents and injuries. For all these reasons, we recommend that you limit the amount of time you use the machine continuously to around 10 minutes per session, and take 10-20 minutes of rest between work sessions. Also try to keep the total amount of work done in a single day under 2 hours or less.

When using the machine remember to wear proper clothing and protective equipment: Hard hat, goggles or face shield, thick work gloves, non-slip work boots, ear protectors and must be carried with you.

3. SYMBOLS ON THE MACHINE

For safe operation and maintenance of your machine, please pay attention to the symbols that are embossed on the machine.

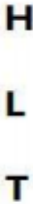
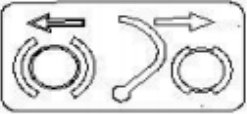
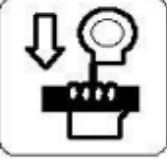
 (a)	<p>(a) The place where to refuel the gasoline mixture. Position: On the fuel tank cap</p>
 (b)	<p>(b) The place to refuel the chain oil. Position: On the oil cap</p>
 (c)	<p>(c) Indication relative to the switch. If the switch is in position "O" the machine will turn off. Position: Rear Left of Machine</p>
 (d)	<p>(d) Starter. Pulling the choke out closes the air intake. Position: Rear Right of Machine</p>
 (e)	<p>(e) Oil regulation terms. "MIN" is the direction to reduce the lube oil output. "MAX" is the address to increase the lube oil output.</p>
 (f)	<p>(f) Position of high speed adjusting screw (H) Low speed adjusting screw position (L) Idle adjusting screw position (T) Place on the machine: rear left of the machine.</p>
 (g)	<p>(g) Chain brake. Forwards the chain is braked. Towards rear the chain is loose and operative.</p>
 (h)	<p>(h) Manual pull start.</p>

4. MACHINE PARTS

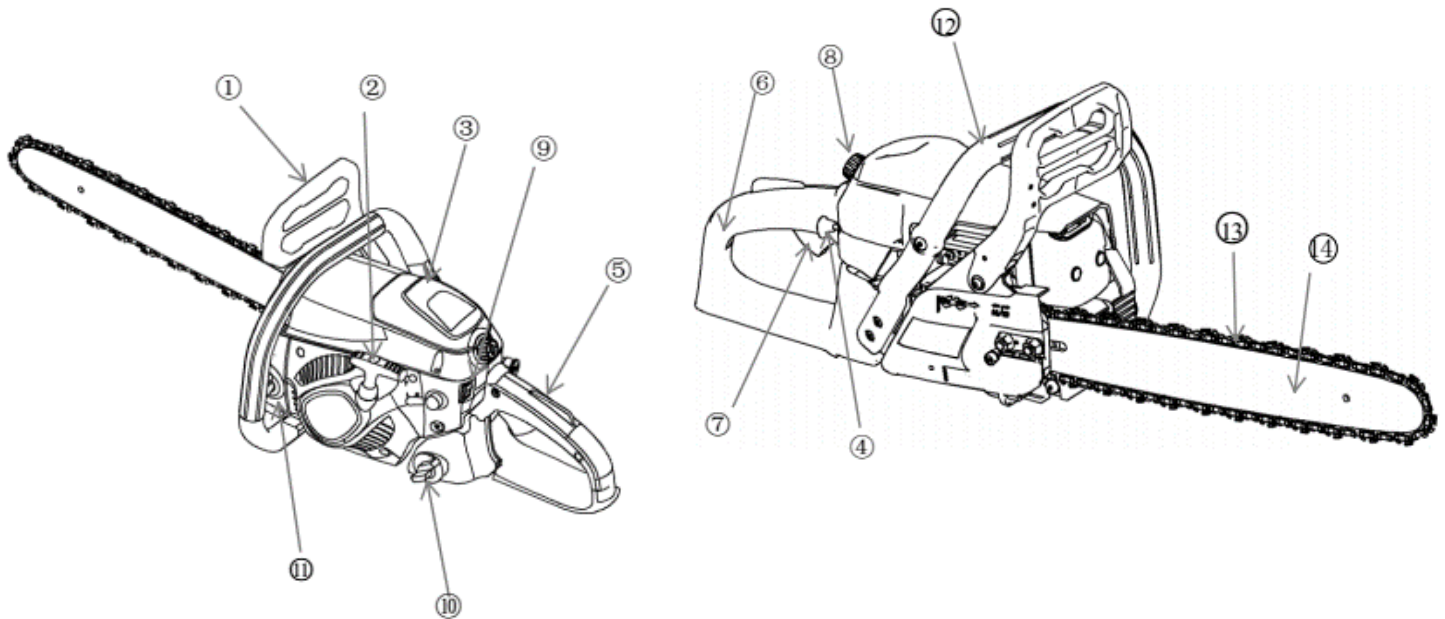

- | | |
|---------------------|---------------------|
| 1. front protection | 8. close button |
| 2. starter puller | 9. off switch |
| 3. Air filter | 10. Fuel tank |
| 4. Throttle | 11. Oil deposit |
| 5. throttle lock | 12. Carrying handle |
| 6. rear handle | 13. String |
| 7. Throttle | 14. Sword |

5. BAR AND CHAIN ASSEMBLY

The standard chain saw package contains the following items:

- (1) Motor (2) Sword protector cover
 (3) Cutting Chain (4) Cutting Sword
 (5) Adjustment screwdriver (6) Spark plug wrench
 (7) Support claw

Open the box and install the bar and chain on the motor unit as follows:
 The chain has sharp edges. Wear protective gloves for your safety.

1. Pull the guard towards the front handle to check that the chain brake is not on.
2. Loosen the nut and remove the chain cover. Attach the spiked bumper with two screws at the forefront of the chainsaw.
3. Remove chain spacer.
4. Put the bar on the motor unit and then push towards the clutch.
5. Fit the chain to the bar, on the chain sprocket to the sprocket and around the bar.

6. Adjust the position of the chain tensioner pin, and then insert the tensioner pin into the lower hole of the bar guide bar. Mount the clutch cover to the motor unit and tighten the mounting nut. While holding the nose of the bar, adjust the chain tension by turning the tensioner screw until the retaining straps touch the bottom of the bar rail.

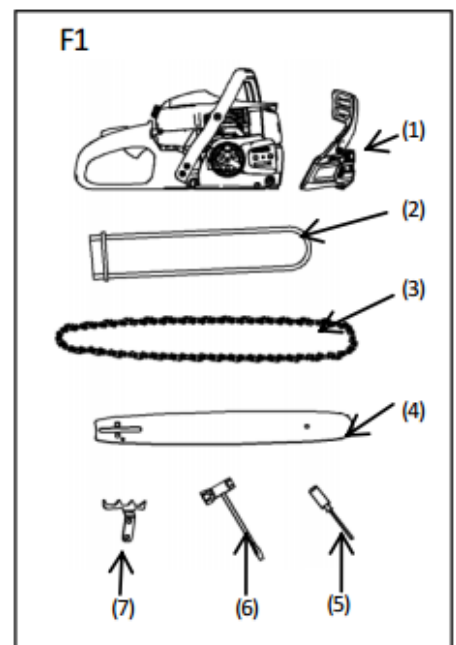

7. Tighten the lock nut with the tip of the bar held (12 ~ 15 Nm). Next, check the chain for smooth rotation and proper tension while moving by hand.

8. Check the tension of the saw chain. Use your hand to lift the chain link positioning it at the center of the cut length with approximately 10N force. If the chain link slips off the entire bar rail, the chain needs to be tightened.

It is very important to maintain proper chain tension. Rapid wear of the guide bar or chain can be caused by improper or poorly adjusted tension. Especially when using a new chain, take good care of it, as you should check it often to avoid such problems.

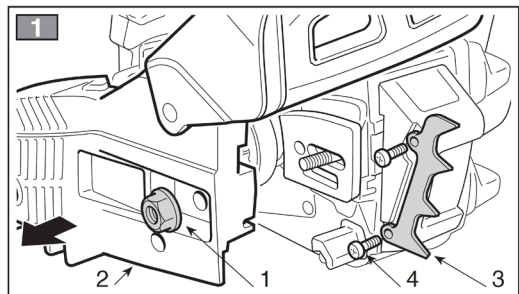

1. Nut
2. clutch cover
3. shock claw
4. Threaded screw

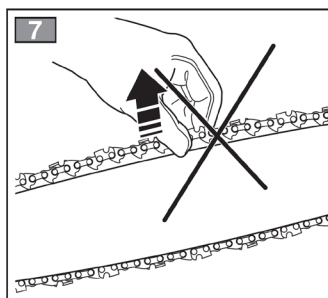
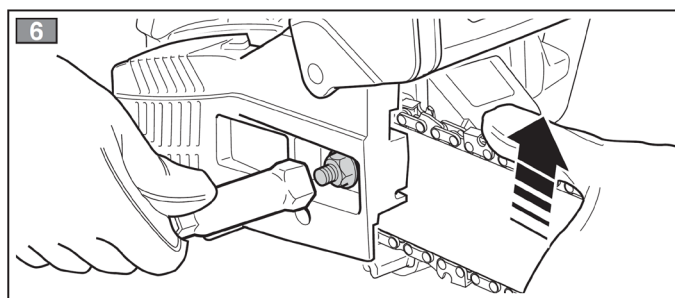
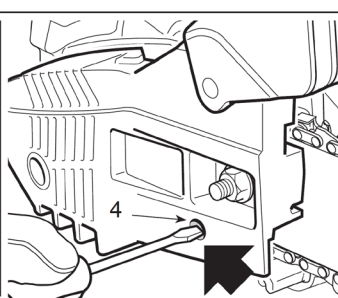
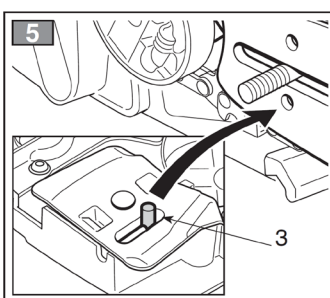
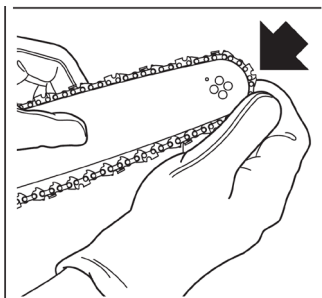
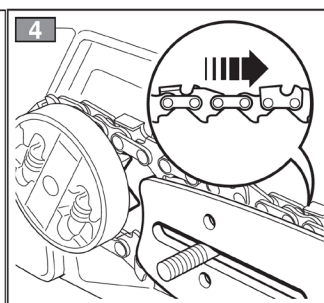
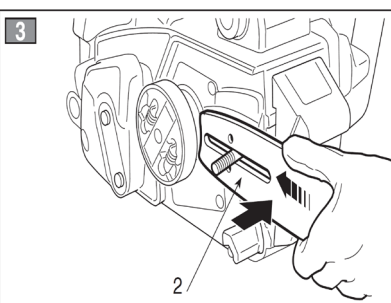
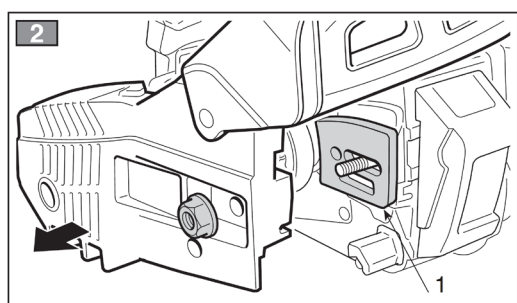

CAUTION WITH KICKBACK!

Kickback can occur when working with the machine. Do not rely solely on the safety devices built into your chainsaw. As a chain saw user, you will need to take some steps to keep yourself and other people and animals around you safe.

With a basic understanding of recoil, you can reduce or eliminate the element of surprise. Sudden kickback contributes to accidents. Therefore, we recommend that you always keep a good, firm grip on the chainsaw with

both hands. A firm grip will help reduce kickback and maintain control of the chainsaw. Also, make sure the area you are cutting is clear of obstructions.

Do not reach or cut above shoulder height and use only manufacturer specified replacement bars and chains or their equivalent.

6. FUEL AND CHAIN OIL

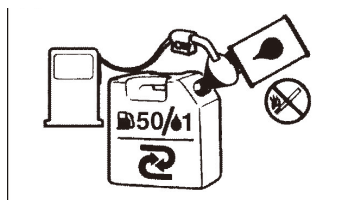

■ FUEL

The engines are lubricated with an oil specially formulated for air-cooled 2-stroke gasoline engines. If oil is not available, use an anti-rust grade added oil that is expressly for use in air-cooled 2-stroke engines.

RECOMMENDED MIX RATIO
PETROL 40 : OIL 1

FUEL WITHOUT OIL (95 OCTANE UNLEADED GASOLINE).

OIL FOR 2-STROKE ENGINES.

HOW TO MIX THE FUEL?

Pre-measure the amounts of gasoline and oil to be mixed. Put some gasoline in a clean fuel container. Pour all the oil and shake well. Pour in the rest of the gasoline and shake again for at least a minute. Place a clear indication on the outside of the container or container to avoid mixing with gasoline or other containers.

Mixing Guide:

Gasoline (L)	one	two	3	4	5
2T oil (ml)	25	fifty	75	100	125

7. BEFORE STARTING TO USE

Check the area you are going to work on and the direction of the cutting object. If there is any obstacle, remove it before turning on the machine. Never start cutting without first reviewing the work area, having made sure and planned your path free from the danger of falling trees or the like.

Be careful and keep other people and animals out of the work area whose diameter is about 3 times the cutting object. Inspect the machine for worn, loose, or damaged parts. Never operate a machine that is damaged, improperly adjusted, or not fully and securely assembled.

Before starting the engine, make sure the saw chain is not in contact with anything. Keep handles dry, clean, and free of oil or fuel mixture. Make sure the chain stops moving when the throttle control trigger is released.

8. USE AND PRECAUTIONS



Always hold the machine firmly with both hands when the engine is running. Use a firm grip with your thumb and fingers surrounding the handles. Keep all parts of your body away from the machine when the engine is running.



Never touch the muffler, spark plug or other metal parts of the engine while the engine is running or immediately after stopping the engine. Doing so could cause severe burns or even electrical shock.

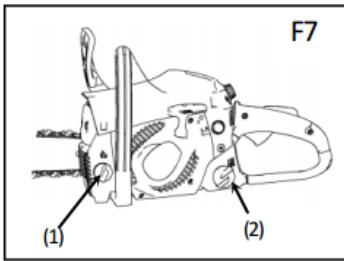

1. Fill the fuel and chain oil tanks, respectively, and tighten the caps securely.

- (1) Chain oil
- (2) Gasoline

2. Put the switch in the "I" position

3. While holding the throttle lever together with the throttle lockout, push the fuel primer to get fuel and release the throttle to hold it in the starting position.

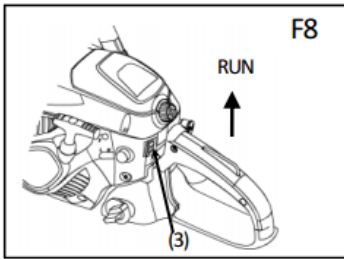

4. When restarting immediately after stopping the engine, leave the choke in the open position.

5. While holding the chainsaw securely on the ground, pull the starter rope sharply, and when the engine has started, press the starter button and pull the starter hose again to start the engine.

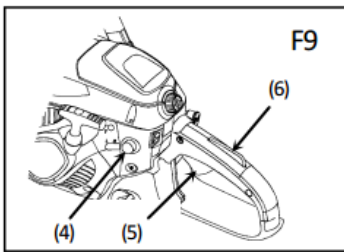

6. Allow the engine to warm up by pressing the throttle lightly. Allow the engine to idle for a few minutes before starting to work at higher revolutions. Stay clear of the chain as it will start to rotate when you start the engine. After starting the engine, run the chainsaw at medium speed and check if the chain oil is distributed properly.

9. OPERATION

Unscrew and remove the fuel cap and oil cap. Fill fuel tank and oil tank to 80% of full capacity. Attach the fuel and oil tank cap securely and clean up any fuel spillage around the unit. Put the switch in the "I" position. Pull to start.

The choke will close and the throttle lever will then stay in the initial starting position. Then press the primer until the fuel enters.

■ CHECK THE OIL

After starting the engine, set the chain speed to "medium speed" and see if the chain oil is distributed properly.

The chain oil flow can be changed by inserting a screwdriver into the hole at the bottom of the clutch side. Turn the shaft counterclockwise to increase the oil flow. Turn the shaft clockwise to decrease the oil flow. Adjust it according to your working conditions.

The oil tank should be almost empty by the time the fuel runs out. You should always fill the tank with oil and gasoline at the same time.

■ CUTTING TIPS

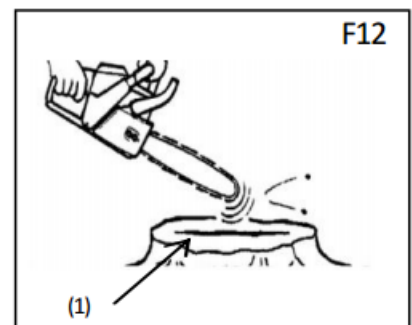

Before continuing with your work, read the section "For Safe Operation", it is recommended to practice cutting simple logs first. This also helps you get used to your unit.



Always follow all safety regulations that may restrict the use of the machine. The chain saw should only be used to cut wood. Cutting other types of material is prohibited. Vibrations and kickback will vary with different materials and the requirements of safety standards will not be met. Do not use the chain saw as a lever to lift, move or split objects. Do not block it on fixed supports. Installing tools or applications on the PTO that

are not specified by the manufacturer is prohibited.

It is not necessary to press the saw into the cut against the trunk. Apply only light pressure while running the engine at full speed.

Daily inspection is recommended before use and after drops or other impacts to identify significant damage or defects.

Loading the engine with the chain caught in a cut can damage the clutch system. When the saw chain is caught in the cut, do not try to force it out, but use a wedge or pry bar to open the cut.

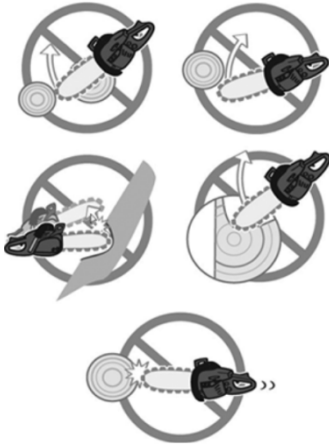
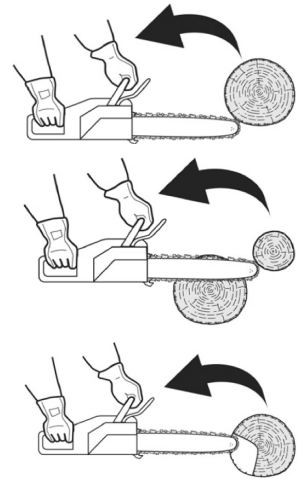

- Kickback protector

This saw is also equipped with a chain brake that will stop the chain from kickback if it works properly. You should check the operation of the chain brake before each use by running the saw at full speed for 1 or 2 seconds and pushing the front hand guard forward. The chain must stop immediately with the engine running at full speed. If the chain stops slowly or does not stop, contact the manufacturer's or importer's service center to replace the brake band and clutch drum before use.



It is extremely important that the chain brake be checked for proper operation before each use and that the chain be sharp to maintain the kickback safety level of this saw. Removal of safety devices, improper maintenance, or incorrect bar or chain replacement can increase the risk of serious personal injury from kickback.

■ felling of a tree

1. Decide felling direction considering wind, tree support, location of heavy branches, ease of work after felling, and other factors.

- (A) Felling cut.
(B) Notch cuts.

2. As you clear the area around the tree, arrange for a good foothold and retreat path.
3. Make a notch one-third of the way into the tree on the felling side.
4. Make a felling cut from the opposite side of the notch and at a level slightly higher than the bottom of the notch.

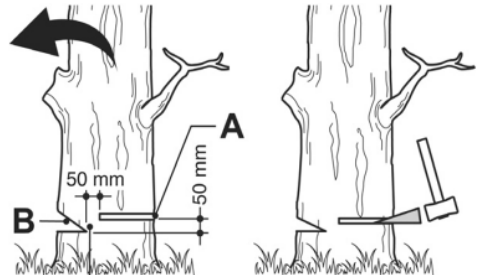

When felling a tree, be sure to warn neighboring workers of the danger.

■ CUTTING LOGS AND LIMBING

1. Always make sure of your footing, as well as the stability of the tree.
2. Watch for the rolling of a cut log.
3. Read the "Safe Operation" instructions to avoid saw kickback.

Before starting work, check the direction of the bending force inside the log to be cut.

Always finish cutting from the opposite side of the bend direction to prevent the guide bar from getting caught in the cut.

Cutting of an unsupported log

Saw halfway through, then roll the log and cut from the opposite side.

Cutting a supported log

In area A in the image above, saw from the bottom one-third and finish sawing from the top. In area B, saw down from the top one-third and finish sawing from the bottom.

Limbing of a felled tree

First check which way the limb is bent. Next, make a shallow cut on the compressed side to prevent the limb from tearing. Cut through the tight side.



Be alert to the kickback of a cut limb that is compressed or resisting pressure.



Pruning

Cut from below, finish from above

1. Do not use an unstable base or ladder.
2. Don't overextend.
3. Do not cut above shoulder height.
4. Always use both hands to tighten the saw.



The tip bumper should always be attached while using the chainsaw on the tree trunk. Push the spiked bumper into the trunk using the rear handle. Push the front handle in the direction of the cutting line. The spiked bumper must be fixed to follow the guide of the saw if necessary. Use a spiked bumper when cutting trees and thick branches can ensure your safety and lower the work force and vibration level.

If there is an obstacle between the cut material and the chainsaw, turn off the machine. Wait until it stops completely. Wear the safety glove and remove the barrier. If the chain must be removed, follow the instructions in the installation part of the manual. A test should be carried out after cleaning and new installation. If vibration or mechanical noise is discovered, please stop use and contact your dealer.

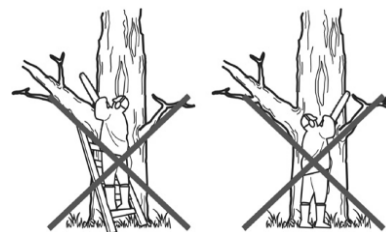
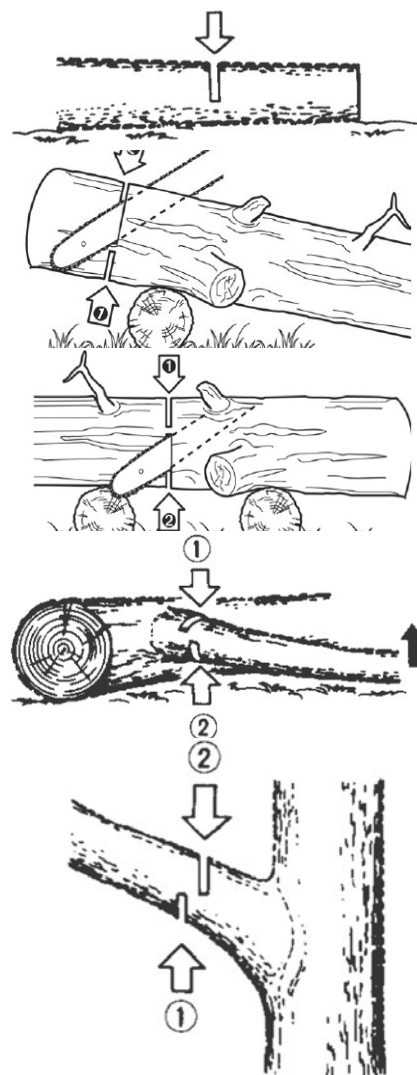

10. MAINTENANCE

Before cleaning or repairing your machine, make sure it is stopped properly. Disconnect the spark plug to prevent possible accidental starting. Follow the instructions for regular maintenance, pre-operation procedures, and daily maintenance routines. Improper maintenance can cause serious damage to the machine.

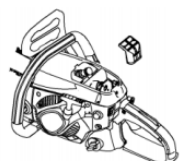

10.1. air filter

Dust on the filter can be removed with a solution of detergent and warm water. To clean the dirt on the screens, remove the filter cap and brush on the gasoline. When using compressed air, blow from the inside.



10.2. The sword

When disassembling the guide bar, remove the sawdust in the groove of the bar and the grease inlet. Grease the bar sprocket.

Check for fuel leaks and loose fasteners and damage to major parts, especially handle joints and guide rod mounting. If any defects are found, make sure they are repaired before using again.

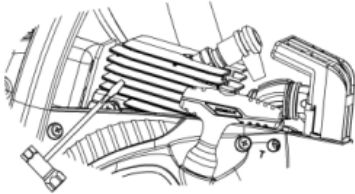
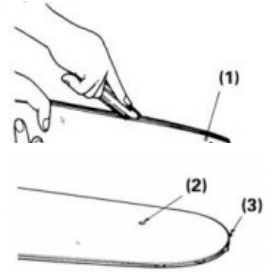

10.3. cylinder fins

Dust clogging between the cylinder fins will cause the engine to overheat. Periodically check the fins after removing the clutch cover, and then use compressed air to clean the cylinder fins.

10.4. Plugs -Clean the electrodes with a wire brush and adjust the 0.65mm gap as needed.

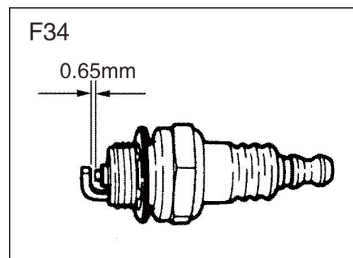
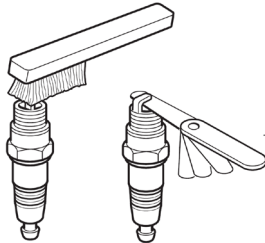

10.5 MAINTENANCE OF THE CHAIN AND THE BAR (SHARPENING)

It is very important to keep the chain and the cutting bar in the best cutting conditions and properly sharpened. Sharpen the chain when the following occurs:

The chip turns into a fine powder.

You need to push and force the chainsaw to cut.

The cut is not straight.

Increase the vibration.

Increase fuel consumption.

Use an appropriate file for sharpening the chain on the machine.

Chain: 3/8LP .050

File diameter: 4.0 mm

Place the file on the tooth and press straight forward. Hold the position as shown in the image.

After each cut, check the depth of the cutting guides and back off as also seen in the picture.

Be sure to round off the end of the guide to prevent kickback or chain breakage.

It is important that each cutting tooth is the same length. And the angles also follow the same measurement as shown in the image.

1. Guide depth gauge.
2. Make sure the guide is rounded.
3. Reference Guide Depth
4. cutting tooth length
5. Side cutting angle
6. top cutting angle

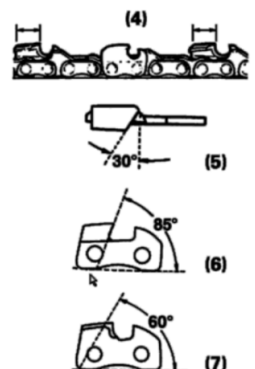
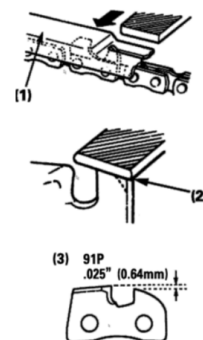
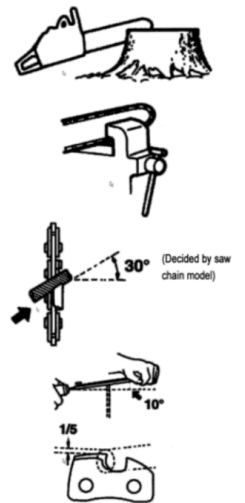



Turn the guide bar over from time to time to prevent uneven wear.
The bar rail must always be square. Check for wear and file to even out imperfections.

1. Rule
2. correct rail
3. wrong rail
4. chain pitch

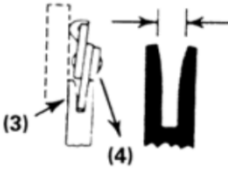

To avoid danger, NEVER use another bar or chain on this machine other than those indicated.
The combination that equips the machine complies with the ANSI B175.1-2000 standard.



Always keep the safety elements of the machine throughout its life of use.
Hazards can occur for the following reasons:

- improper maintenance
- Use of unauthorized components
- Removing or removing security features

11. STORAGE

1. Empty the fuel tank and run the engine without fuel.
2. Empty the oil tank.
3. Clean entire unit.
4. Store the unit in a dry place out of the reach of children.

12. TROUBLESHOOTING

ISSUE	CAUSE	SOLUTION
1) Boot failure	-Replace the fuel if you find water or another mixture of inferior quality. -Check in case of engine flooding. -Check the spark plug	-Replace with proper fuel. -Remove and pull out the spark plug wire. -Then pull the starter again without primer. -Replace with a new one.
2) Lack of power/poor acceleration/rough idle	-Check the fuel for water or some inferior quality mixture. -Check the air filter for clogging -Check the carburetor for improper adjustments.	-Replace with proper fuel. clean Readjust needle speed
3) Oil does not come out	-Check for inferior quality oil -Check the oil passage for any obstruction	replace clean

Should the unit require additional overhaul service, please consult an authorized ANOVA service facility in your area.

13.WARRANTY

This product is guaranteed in accordance with legal regulations for a period of 12 months from the date of purchase by the first user.

This warranty covers all material or production faults, does not include defects in normal wear parts, such as bearings, brushes, cables, plugs or accessories such as drills, bits, saw blades, etc., damage or defects resulting from abuse , Accidents or alterations; Not even transportation costs.

We reserve the right to reject any claim where the purchase cannot be verified or where it is clear that the product was not properly maintained. (Clean ventilation slots, regularly maintained carbon brushes...)

Your purchase receipt should be kept as proof of purchase date.

Your non-disassembled tool must be returned to your dealer in an acceptable clean condition, in its original molded case, if applicable to the unit, accompanied by your proof of purchase.

14.ENVIRONMENT



If your machine needs to be replaced after extended use, please do not put it in household waste, dispose of it in an environmentally safe manner. Never pour chain lube residue or 2-stroke fuel mixture down the drain or onto the ground. You must go to a special collection or dump point.

If the machine is to be disposed of or no longer needed, do not dispose of the device with your household waste, but dispose of it in an environmentally friendly manner.

Completely empty the oil/lubricant and fuel tanks and dispose of the waste at a special collection point or dump. Please also dispose of the device itself at an agreed collection/recycling point. By doing so, the plastic and metal parts can be separated and recycled. Information regarding the disposal of materials and devices are available from your local administration.

15. EXPLODED

MG3514 **ALNOVA**

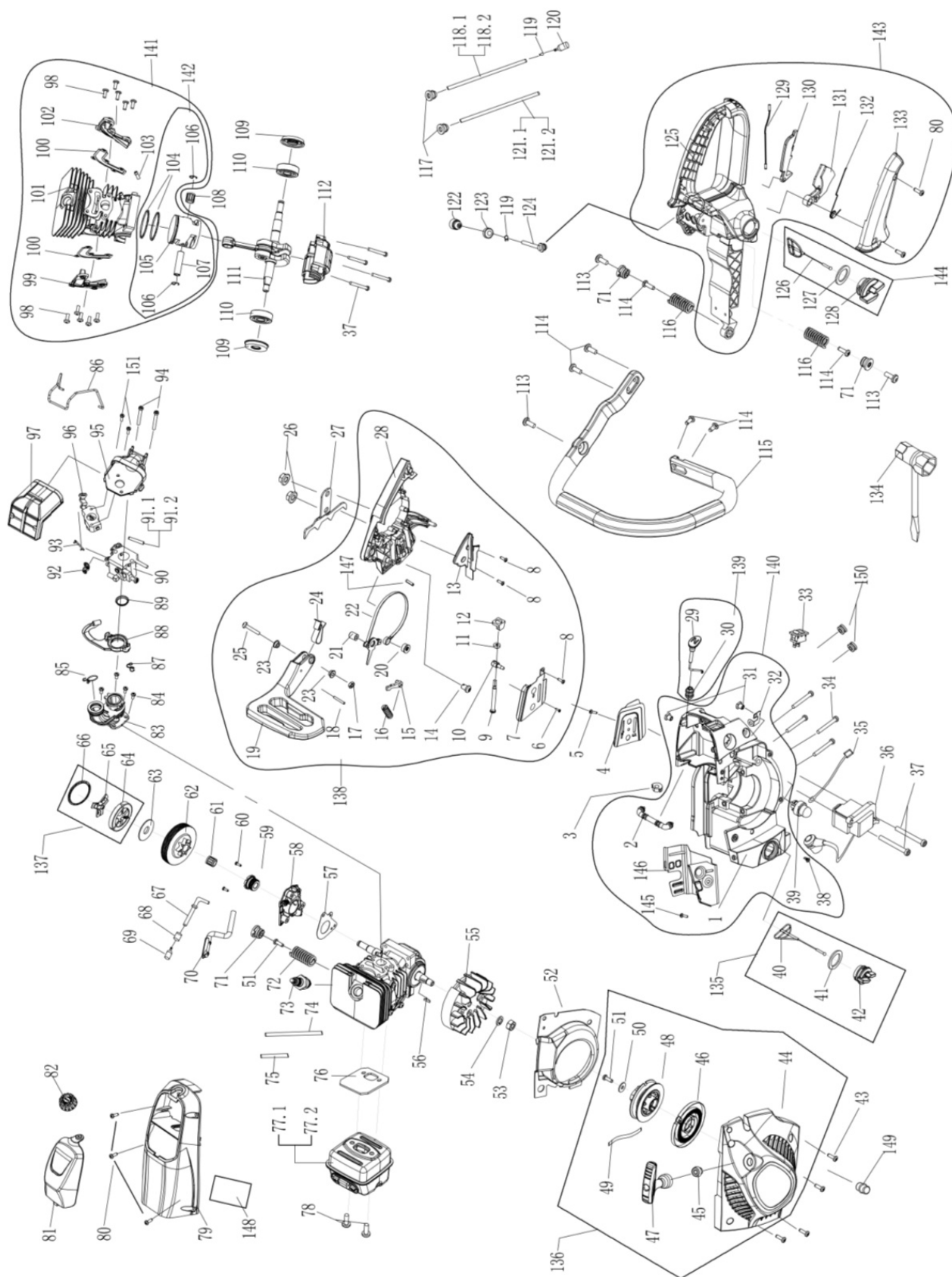



DISTRIBUTION COMPANY

MILLASUR, SL
RUA EDUARDO PONDAL, Nº 23 PISIGÜEIRO
15688 OROSO - A CORUÑA
SPAIN



EC DECLARATION OF CONFORMITY

In compliance with the different CE directives, it is hereby confirmed that, due to its design and construction, and according to the CE mark printed by the manufacturer on it, the machine identified in this document complies with the relevant and fundamental health and safety requirements. of the aforementioned EC directives. This declaration validates the product to display the CE symbol.

In the event that the machine is modified and this modification is not approved by the manufacturer and communicated to the distributor, this declaration will lose its value and validity.

Machine name: CHAINSAW

Model: **MG3514**

Recognized and approved standard to which it conforms:

Directive 2006/42/CE
Directive 97/68/EC~ 2012/46/EU

According to standard:

EN ISO 11681-1:2011 (BM50377712 0001)

Company seal

millasur
Rúa Eduardo Pondal, nº 23
Pol. Ind. Sigüeiro - 15688 Oroso - A Coruña
Tlf. 981 696465 / Fax. 981 690861

04/10/2018