

Transport trolley

CR06150

ANOVA

Instructions and user manual



EN

Millasur SLU
Rúa Eduardo Pondal, nº 23 - Pol. Ind. Sigüeiro
15688 - Oroso - A Coruña - 981 696 465 - www.millasur.com





Anova We would like to congratulate you on choosing one of our products and guarantee the assistance and cooperation that has always distinguished our brand over time.

This machine is designed to last for many years and to be of great use if used according to the instructions in the user manual. We therefore recommend that you carefully read this instruction manual and follow all our recommendations.

For more information or questions, you can contact us through our web support at www.anova.es.

INFORMATION ABOUT THIS MANUAL

Pay attention to the information provided in this manual and on the appliance for your safety and the safety of others.

- This manual contains instructions for use and maintenance.
- Take this manual with you when you go to work with the machine.
- The content is correct at the time of printing.
- We reserve the right to make changes at any time without affecting our legal responsibilities.
- This manual is considered an integral part of the product and must remain with it in case of loan or resale.
- Request a new manual from your distributor if it is lost or damaged.

READ THIS MANUAL CAREFULLY BEFORE USING THE MACHINE



To ensure your machine delivers the best results, carefully read the usage and safety guidelines before using it.

OTHER WARNINGS:

Improper use could cause damage to the machine or other objects.

Adapting the machine to new technical requirements could cause differences between the content of this manual and the purchased product.

Read and follow all instructions in this manual. Failure to follow these instructions could result in serious personal injury.

INDEX

1. SAFETY INSTRUCTIONS
2. PRODUCT DESCRIPTION
3. TECHNICAL SPECIFICATIONS
4. ASSEMBLY AND OPERATION
5. MAINTENANCE AND CLEANING
6. TROUBLESHOOTING
7. WARRANTY
8. ENVIRONMENT
9. PARTS BREAKDOWN
10. CE CERTIFICATE

1. SAFETY INSTRUCTIONS

1.1. Safety instructions

Important

Before operating this product, please read and follow the instructions below. To prevent injury to yourself and others, you should also follow local safety regulations.

Keep these instructions for future reference. This manual contains safety information to inform you about the hazards and risks associated with the product and how to prevent them. It also contains important instructions that must be followed during product setup, operation, and maintenance.

It is important that you read and understand these instructions before attempting to operate this equipment. Make sure you are fully familiar with the controls and the correct use of the product.

Throughout this manual, you will find notices that provide safety instructions and information about hazards that could cause personal injury and/or property damage. These include a warning icon to indicate the likelihood and potential severity of injury.

- **Danger/Warning:** Indicates a hazard that, if not avoided, could result in serious injury.
- **Important/Caution:** Indicates a hazard which, if not avoided, could result in minor or moderate injury.
- **Note/Notice:** Indicates information considered important but not related to hazards.

For your safety, carefully read these operating instructions. Familiarize yourself with the controls and proper use of the device. Failure to follow these safety information and instructions may result in serious injury or death. Share these operating instructions with other users of the device.

Before starting work: Have qualified personnel show you how to safely operate the device.

First, familiarize yourself with the device in a large, open, and flat area.

1.1.1. Intended use

The machine must only be used for its intended purpose! Any other use will be considered misuse.

To use the machine correctly, you must also respect and follow all safety regulations, assembly instructions, and operating and maintenance instructions set out in this manual.

All persons who use and maintain the machine must be familiar with this manual and must be informed about the possible risks of the machine.

The machine is used for:

Transporting goods within the maximum permitted load capacity

Any manipulation of the machine or its components is considered misuse; in such a case, neither MASCHINEN nor its business partners may be held liable for ANY direct or indirect damage.

⚠ Warning

Removing or modifying safety components may cause damage to equipment and serious injury.

1.1.2. Environmental conditions

The machine can operate under the following conditions:

- Humidity: max. 70%
- Temperature: +5°C to +40°C (+41°F to +104°F)

The machine, especially the battery, should not be exposed to temperatures above approximately 80°C. Do not store it in direct sunlight or for extended periods in the trunk of a car.

Prohibited uses:

- It is forbidden to use the machine outside the technical limits indicated in this manual.
- It is forbidden to use the machine without the supplied protective devices.
- It is forbidden to use the machine if it is not suitable for the intended use and is not certified.
- It is forbidden to use the machine if it does not meet the required dimensions.
- Any manipulation of the machine and its parts is prohibited.
- It is forbidden to use the machine for any purpose other than that described in this user manual.
- Leaving the immediate work area while performing tasks is not permitted.

1.2. Safety instructions

Any missing or illegible security labels must be replaced immediately.

Local laws and regulations may specify the minimum operator age and limit the use of this machine.

To avoid malfunctions, machine breakdowns and injuries, please read the following safety instructions.

1.2.1. General

- Use the machine only in suitable lighting conditions that ensure safe operation.
- It is forbidden to operate the machine if you are tired, lack concentration, or are under the influence of substances harmful to your health.
- Caution on slippery surfaces: danger of slipping, risk of injury. Wear sturdy, slip-resistant footwear while working. Slips, trips, and entrapments are a major cause of serious injury or death.
- The machine should only be operated by trained people (who know and understand this manual) and who do not have limitations in their motor skills compared to conventional workers.
- Operate the machine with both hands.
- Unauthorized persons, especially children and untrained personnel, should be kept away from the operating machine.
- If you give the machine to a third party, these instructions must be included with the machine. Before putting it into operation, after a breakdown or damage, check the device and make sure it is in good working order.

- Take extra care when working near swimming pools or garden ponds. Never use the machine in the rain or in wet or damp areas. Disconnect the battery before any maintenance or adjustments!

1.2.2. Charger

- This charger is designed exclusively for charging the battery of this device. Charging other batteries is not permitted.
- Never use the charger in a wet or humid environment.
- Disconnect the cable connections by pulling only on the plug. Pulling on the cable could damage it and the plug, and electrical safety would no longer be guaranteed.
- Never use the charger if the cable, plug, or the device itself is damaged due to external causes. Take the charger to the nearest repair shop.
- Do not use the appliance near heat sources.
- Do not use an extension cord to power the charging station.
- Do not place metal objects near the charger's charging contacts. Do not open the charger. In case of malfunction, contact a qualified repair shop.
- Only use the original charger to recharge the battery. Using other chargers may cause damage or risk of fire.

1.2.3. Battery

- Improper use or use of damaged batteries that emit fumes. Go outside and seek medical attention if you experience discomfort. Fumes can irritate the respiratory tract.

Fire danger

Never charge batteries near acids or flammable materials.

- Charge the battery only at an ambient temperature between 0°C and +40°C. Allow it to cool down after a heavy charge.

Explosive

Protect the battery from heat and fire.

- Use the battery only at an ambient temperature between 0 °C and +45 °C.

Short circuit

For disposal, transport or storage, the battery should be placed in a plastic bag or box, or the contacts should be covered with adhesive tape.

- Never open the battery.

1.3. Residual risks

⚠ Important

Even if it complies with the relevant product safety regulations, residual risks may exist given the characteristics of the equipment and the work for which it has been designed.

Despite the intended use, certain residual risks remain. Due to the machine's design and construction, hazardous situations may occur, which are identified as follows in these operating instructions:

A safety warning worded in this way indicates an imminent danger that, if not avoided, will result in death or serious injury.

A safety warning of this type indicates a potentially dangerous situation that, if not avoided, could result in serious injury or even death.

Note: Even if you take preventive measures, there may be residual, non-obvious risks.

2. PRODUCT DESCRIPTION

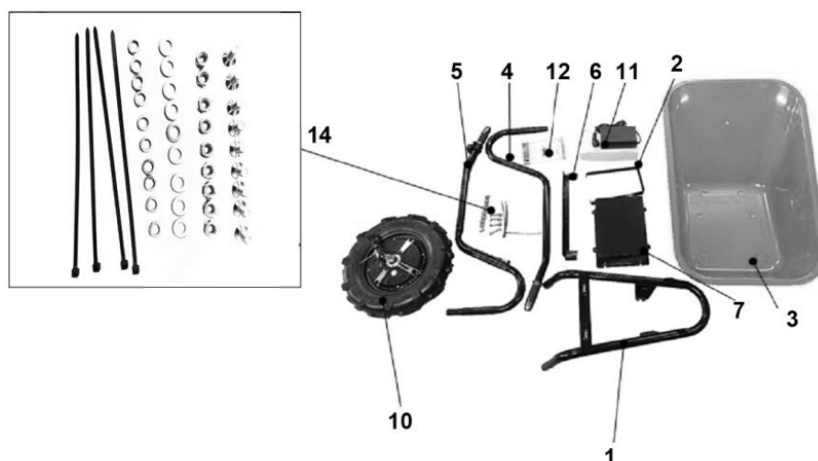

- | | |
|----------------------------------|------------------------------|
| 1. Front frame | 7. Battery set |
| 2. U-shaped support for the tray | 8. Handle cover |
| 3. Tray | 9. Speed control lever |
| 4. Left handle | 10. Wheel and motor assembly |
| 5. Right handle | 11. Charger |
| 6. Reinforcement | 12. Instruction Manual |
| 7. Battery set | 14. Screws, nuts and flanges |

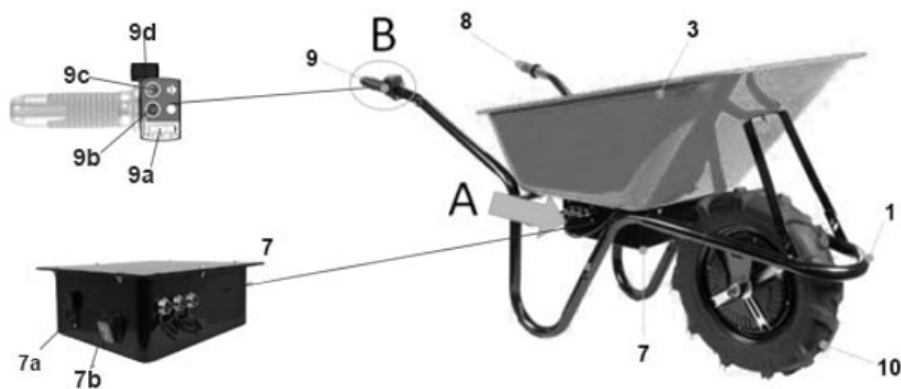

- | | |
|---|--------------------------------|
| 1. Front frame | 9. Engine control element |
| 3. Tray | 9a. Battery capacity indicator |
| 7. Battery box system | 9b. Brake button |
| 7a. Plug for the battery charging cable | 9c. Direction button |
| 7b. On/Off switch | 9d. Throttle lever |
| 8. Handle | 10. Wheel and motor assembly |

3. TECHNICAL SPECIFICATIONS

Characteristics	
Maximum load	150 kg
Ability	100 L
Engine	280 W
Battery	24 V – 12 Ah
Autonomy	35 km
forward speed	0-6 km/h
Forward [reverse] speed	0-2 km/h
Wheel	5.00-8"
Weight	39 kg

Note: Due to design improvements and/or changes in specifications, this manual may be modified without prior notice and without needing to change the document.

4. ASSEMBLY AND OPERATION

4.1. Mounting

Please check the contents of the product immediately upon receipt for any damage caused during transport or missing parts. Claims for transport damage or missing parts must be submitted immediately after initial receipt and unpacking of the machine, before it is put into operation. Please understand that claims submitted after this time will not be accepted.

⚠ Warning

Do not fully tighten all screws until assembly is complete.

4.1.1. Assembly steps

Step 1

Attach the left (L) and right (R) handle to the frame (1) using a hex screw (4), two washers (5), a spring washer (6), and a nut (7) for each one.

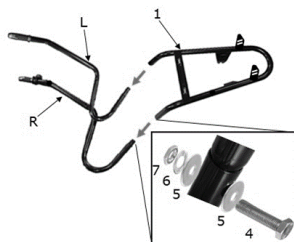

Step 2

First, remove the nuts (4) and washers (5) attached to both sides of the motor wheel (1). Attach the motor wheel (1) to each side of the frame (2) using a washer (5) and a nut (4). Note: The wheel must be mounted so that the cable (3) is on the right side.

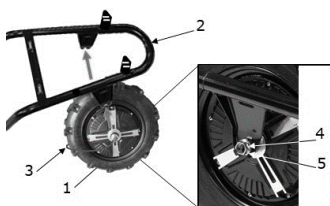
**Step 3**

Attach the bracket (1) to the handles (L, R) using a hex screw (2), two washers (3) and a nut (4) for each.

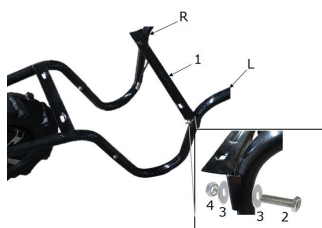
**Step 4**

Secure the motor wheel cable (1) to the frame (2) with cable ties (3).

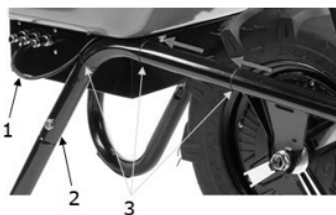

Secure the cable (4) to the right handlebar (R) with cable ties (3).

**Step 5**

Install the battery box system (2) in the holes (1) provided for it in the tray.



Secure the battery box system (2) with a round head screw (3), washer (4), spring washer (5) and nut (6) for each.

Step 6

Attach the tray (1) to both struts (6) using a total of 4 round head screws (2), 4 washers (3), 4 spring washers (4) and 4 nuts (5).

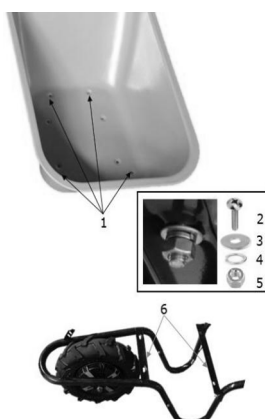

Step 7

Hook the front support (1) into the two longitudinal holes (2) on the frame and slide it forward.

Attach the front support (1) to the tray with a round head screw (3), a washer (4), a spring washer (5) and a nut (6).

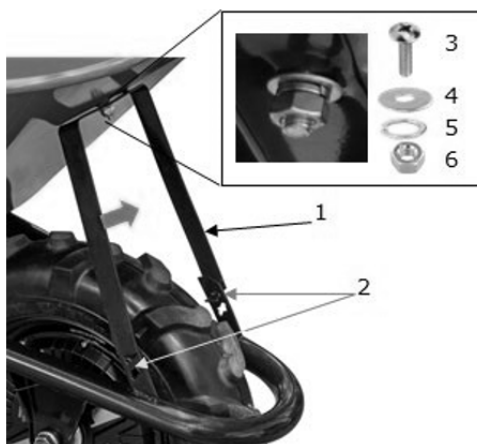

Step 8

Connect the 6-pin plug to position (1), the 5-pin plug to position (2), and the 3-pin plug to position (3).

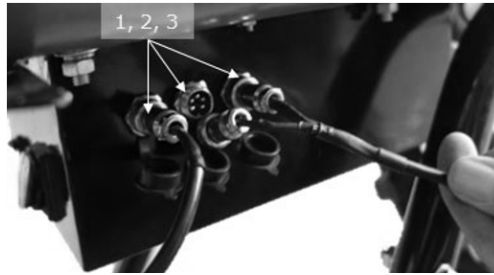

4.2. Operating instructions

4.2.1. Start the machine

1. Set the battery box system on/off switch (1) to the "I" = ON position.



2. Lights #L1 (green) and #L3 (green) turn on.
3. Pressing accelerator lever #1 will make the forklift move forward.
4. If you press direction button #2 once, light #L2 will turn on; pressing accelerator lever #1 will make the forklift reverse.
5. If you press brake button #3, light #L3 will turn red, the EBS brake will be activated, and the forklift will not move, even if you press accelerator lever #1. Press button #3 again and the EBS will be deactivated.

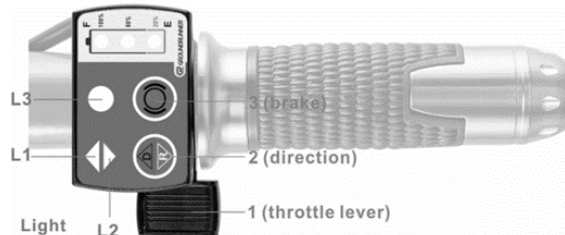

4.2.2. Machine stop

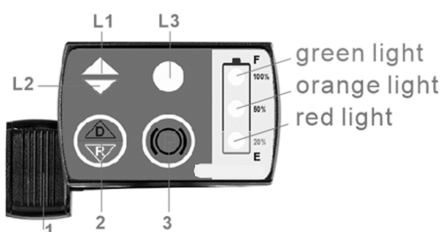

When accelerator lever #1 is activated, the battery charge level is indicated as follows:

- The three LEDs (green, orange and red) light up: battery charge level between 100% and 50%.
- Only the red and orange LEDs light up: battery charge level between 50% and 10%.
- Only the red LED is lit: please charge the battery.

Set the battery box system power switch (3) to the "O" = off position.



4.2.3. Charger

Battery charging

1. Connect the charger to the 230V/50Hz mains power supply (AC outlet) and the charger connector (1) to the battery box system.



2. Charge the battery until only the red LED lights up.



3. When the battery is fully charged, the charger's indicator light will turn green.
4. Disconnect the charger from the power outlet and unplug it.



5. MAINTENANCE AND CLEANING

5.1. Maintenance

⚠ Danger

Disconnect the battery before performing any maintenance or adjustments. Risk of serious injury due to unintentional or automatic activation of the machine.

The machine does not require extensive maintenance. In case of breakdowns or defects, it should only be repaired by qualified personnel.

⚠ Attention

Clean the machine regularly after each use: this prolongs its lifespan and is a requirement to ensure a safe working environment.

Repairs should only be carried out by properly trained professionals.

- Periodically check the condition of the security labels. Replace them if necessary.
- Check the machine's condition periodically.
- Store the machine in a closed, dry place.

Maintenance plan

After each work shift: Check the cables (that they are properly secured and undamaged).

5.2. Cleaning

⚠ Attention

The use of certain products containing ingredients harmful to metal surfaces, as well as the use of abrasive products, will damage the machine's surface.

- Clean the surface of the machine with a damp cloth soaked in a mild solution.
- Never use running water or a pressure washer to clean the machine.
- Clean the exterior parts with a damp sponge.
- Never clean electronic parts with water.
- Check the machine and remove any deposits and/or residue with a brush.

5.3. Storage

- Thoroughly clean all components before storing them.
- Store all components separately in a dry place at a temperature no lower than -10 °C.
- Fully charge the battery before storing it.

⚠ Attention

In case of prolonged inactivity, and at least after one month, recharge the battery.

6. TROUBLESHOOTING

The following table contains the most common problems and their solutions. If further problems arise, contact your nearest authorized service center.

Note: If you cannot resolve the product issues, please contact your official distributor.

Before starting work to fix the defects, disconnect the battery.

Problem	Possible cause	Resource
No electricity supply	The battery is not charged	Recharge the battery
	The engine has seized.	Check the engine
	The ignition switch is damaged	Check the switch
	Broken or loose cables	Check the cables
The battery is not charging	Loosen the cable	Check the cable connection

Note: If you have any questions or problems persist after performing the above operations, please contact your official distributor.

7. WARRANTY

If your product suffers any manufacturing defect during the established warranty period, please contact or go directly to your point of sale with the necessary documentation.

Your purchase receipt should be kept as proof of the purchase date. Your tool must be returned to your distributor in acceptable and clean condition, in its original molded case, if applicable, along with your corresponding proof of purchase.

7.1. Warranty period

The legal warranty period for the product begins on the original date of purchase by the first initial buyer and its duration will be that established by the Royal Decree-Law on the protection of consumers and users against situations of social and economic vulnerability of the year corresponding to the time of acquisition of the product.

Some countries do not have limitations on how long an implied warranty lasts or do not allow the exclusion or limitation of consequential or incidental damages, in which case the above limitation and exclusion may not apply to you. This warranty gives you specific legal rights, and you may also have other rights that vary from state to state or country to country.

7.2. Exclusions

This warranty does not cover product damage or performance problems caused by:

- Natural wear and tear from use.
- Misuse, negligence, careless operation, or lack of maintenance.
- Defects caused by improper use, damage caused by handling by personnel not authorized by Anova or use of non-original spare parts.
- Defects in normal wear parts, such as bearings, brushes, cables, plugs or accessories such as drills, drill bits, saw blades, etc.
- Damage or defects resulting from abuse, accidents, or alterations.
- Incorrect use and storage (explicit reference to the fact that the rules described in the operating instructions have not been followed).
- Wear and tear caused by the customer (e.g., broken saw blades, consumed carbon brushes, etc.).
- Wear and secondary damage due to lack of maintenance, repair, lubricants (e.g., overheating damage due to blocked cooling slots, bearing damage as a result of dirt, frost damage, etc.)
- Damage as an obvious result of overuse/overload.
- Damage caused by inappropriate supplies (e.g., incorrect fuel)
- Load-induced breakage of housing components or accessories due to abnormal stress
- Load-induced deformation of the housing components or accessories due to abnormal stress.
- Damage resulting from the operation of supplies that are overfilled or leak due to improper storage, improper cleaning agents, or other damaging chemical components.
- Damage due to improper exposure to extreme temperatures (e.g., frost cracking, thermal deformation of components, etc.)
- Damage from permanent exposure to ultraviolet radiation.
- Damage caused by inadequate maintenance.
- Any damage caused by failure to follow the instructions in the instruction manual

- Any product that has been repaired by an unqualified professional.
- Any product connected to an unsuitable power source (amps, voltage, frequency).
- Any damage caused by external influences (water, chemicals, physical, impacts) or foreign substances.
- Use of unsuitable accessories or parts.
- It does not cover defects in normal wear and tear parts, nor does it cover damage or defects resulting from abuse, accidents or alterations, nor transportation costs.

Furthermore, the warranty is voided if the product has been altered or modified, or if the trademark/serial number of the machine has been defaced or removed.

Routine maintenance, tuning, adjustments, or normal wear and tear are not covered under this warranty.

This manual does not cover all possible situations regarding warranty exclusions; for more information, please contact your nearest Anova distributor.

7.3. In case of incident

The warranty must be correctly completed with all the requested information, and accompanied by the purchase invoice.

Anova reserves the right to refuse any claim where the purchase cannot be verified or where it is clear that the product was not properly maintained (maintenance, clean ventilation slots, lubrication, regularly maintained carbon brushes, cleaning, storage, etc.).

Private use is defined as personal domestic use by an end consumer. Commercial use, on the other hand, means all other uses, including uses for business purposes, income generation, or rental. Once the product has been used for commercial purposes, it will be considered a commercial product thereafter for the purposes of this warranty.

These are our standard warranty terms, but occasionally there may be additional warranty coverage not specified at the time of publication. For more information, please contact your nearest authorized Anova dealer or visit www.millasur.com.

Warranty service is only available through authorized Anova distributors. You can find your nearest distributor on our distributor map at www.anova.es.

8. ENVIRONMENT



It is essential to ensure that products and their components are disposed of responsibly to protect the environment. Below, you will find general guidelines for the proper disposal of various materials used in your machine.

Dispose of your machine in an environmentally friendly way. We shouldn't throw machines away with the regular household waste. Their plastic and metal components can be sorted according to their type and recycled.

When disposing of machinery or metal products, it's important to remember that their metal components, such as iron, steel, or aluminum, must be properly recycled at metal recycling facilities. This will contribute to their potential reuse in the manufacture of new products.

Oils and Fuels

Used oils and fuels, among other things, must be recycled properly. Do not pour these liquids down drains, into soil, rivers, lakes, or seas, as they can cause serious environmental damage. Take them to a recycling center or specialized collection point. This process helps prevent water and soil contamination and allows for the safe reuse of oils, if possible.

Plastics

Plastics should be separated and taken to designated recycling points. Do not throw them away with regular household waste. Plastics can be recycled, helping to reduce waste.

Cardboard

Packaging materials, such as cardboard, are recyclable. Be sure to separate clean, dry cardboard and place it in designated recycling containers or at an official waste collection point. Do not dispose of it with household waste.

Batteries

Batteries and other electronic components from machines must be disposed of at designated collection points to prevent the release of toxic substances into the environment. Do not throw them away with regular trash. Take them to appropriate recycling centers for safe and responsible handling.

By following these guidelines, you contribute to environmental protection and resource conservation. For more information on material disposal and recycling, please contact your local authorities and consult the necessary information.

9. PARTS BREAKDOWN

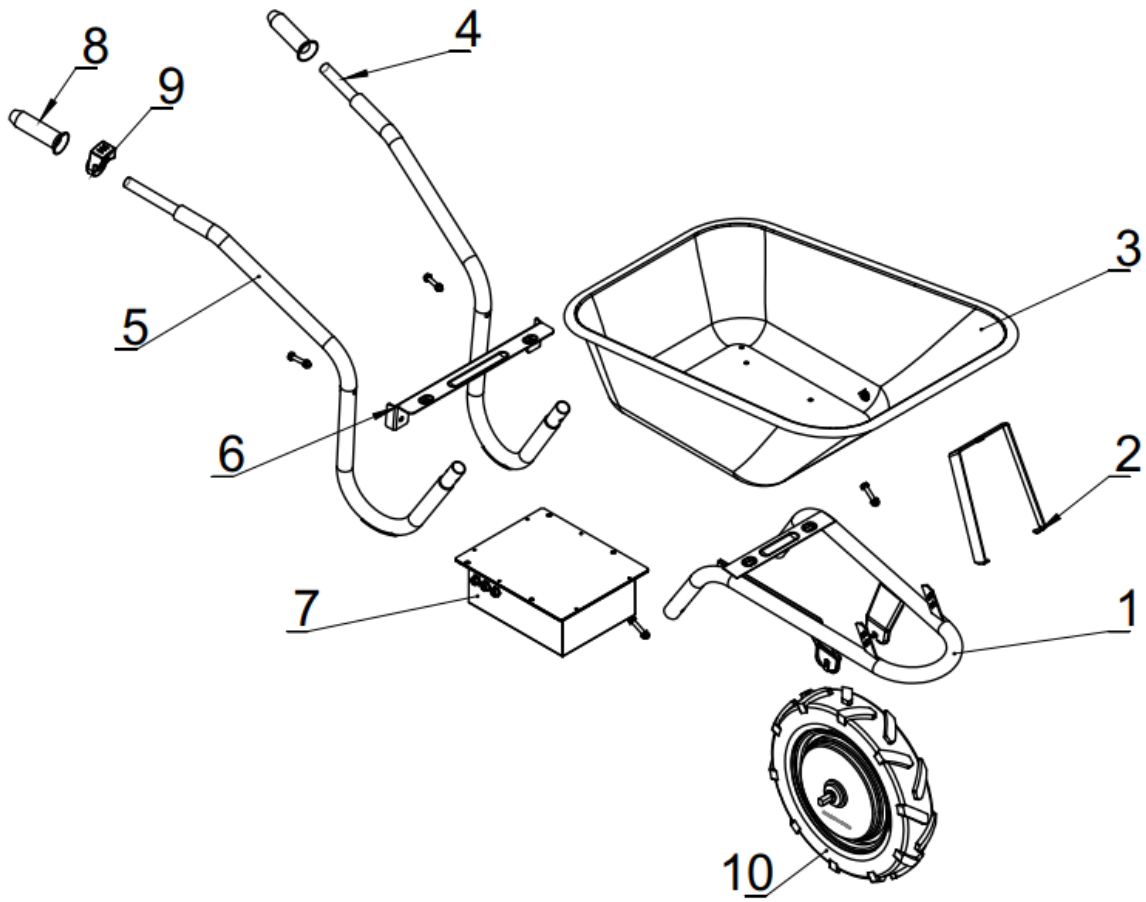

10. CE CERTIFICATE

DISTRIBUTION COMPANY

MILLASUR, SLU

RUA EDUARDO PONDAL, Nº 23 PISIGÜEIRO

15688 OROSO - A CORUÑA

SPAIN



CE DECLARATION OF CONFORMITY

In compliance with the various EC directives, this document confirms that, due to its design and construction, and as indicated by the CE marking affixed by the manufacturer, the machine identified herein meets the relevant and fundamental health and safety requirements of the aforementioned EC directives. This declaration authorizes the product to display the CE marking.

In the event that the machine is modified and this modification is not approved by the manufacturer and communicated to the distributor, this declaration will lose its value and validity.

Machine name: TRANSPORT CART

Model: **CR06150**

[EWB150Q]

Tested according to regulations:

EN 60204-1:2018
EN ISO 12100:2010
EN IEC 61000-6-1:2019
EN 61000-6-3:2007+A1:2011+AC:2012
EN IEC 61000-3-2:2019
EN 61000-3-3:2013+A1:2019

Company seal

MILLASUR, S.L.U.
Rúa Eduardo Pondal, 23 - Pol. Emp. Sigüeiro
15688-Oroso-A Coruña
Tel. (+34) 981 69 64 65 - Fax (+34) 981 69 08 61
e-mail: millasur@millasur.com
CIF: B-15 749 922

09/02/2026