

ALNOVA

MA97

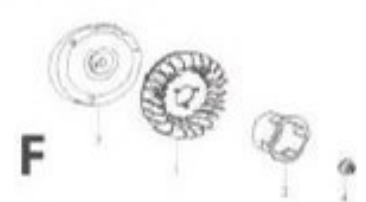
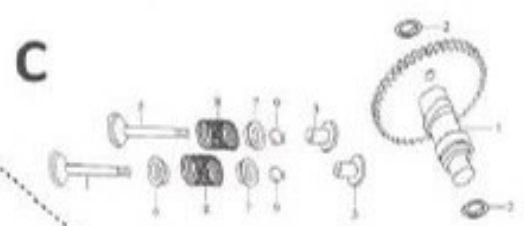
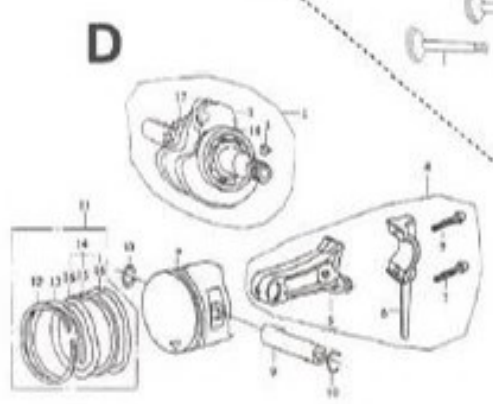
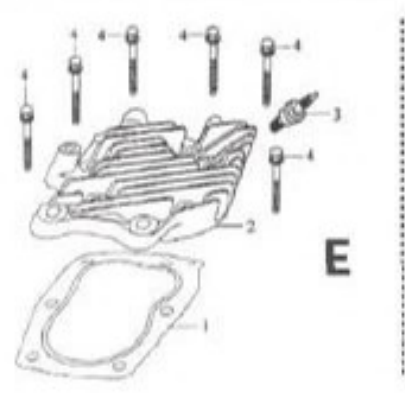
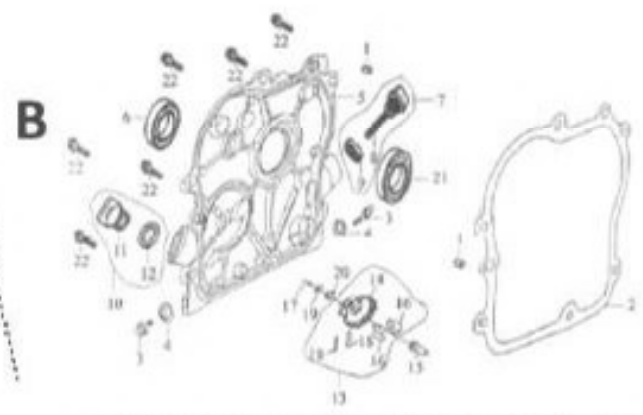
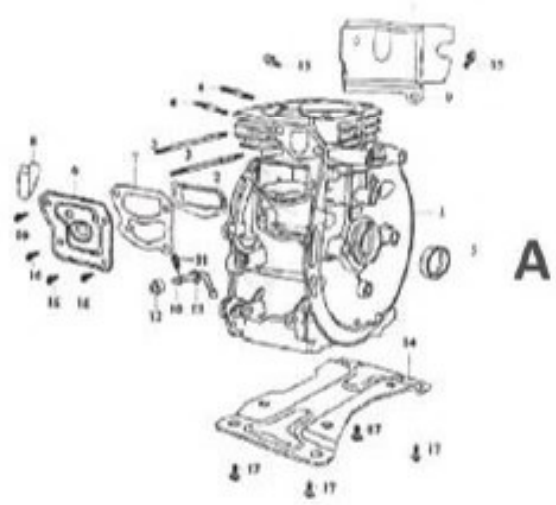
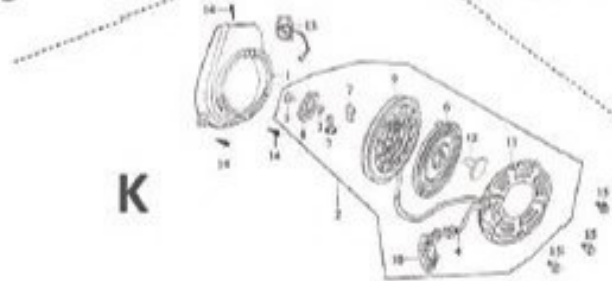
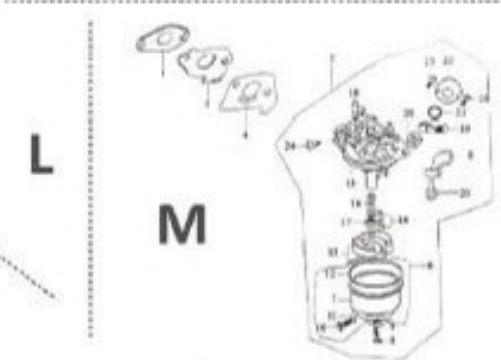
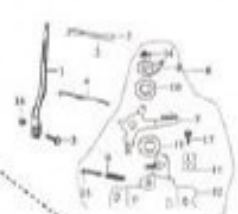
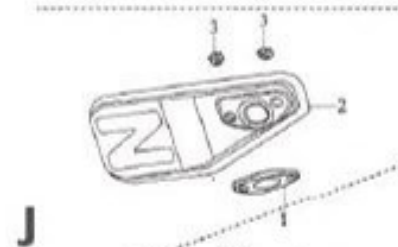
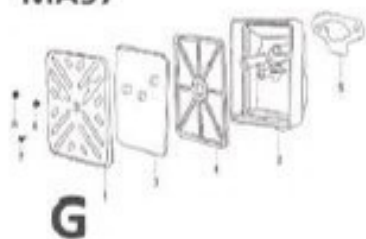

ADAPTABLES AL MODELO MA97

Ref.	Descripción	Ref.Despiece	PVP
MA97-01	CARBURADOR	M2	22,92 ¢
MA97-02	DEPOSITO GASOLINA	I1-I5-I4	9,72 ¢
MA97-03	FILTRO ENTRADA TANQUE GASOLINA	I5	1,12 ¢
MA97-04	FILTRO DE AIRE COMPLETO	G1-G7	3,17 ¢
MA97-05	FILTRO DE AIRE ESPUMA	G3	0,38 ¢
MA97-06	CARCASA ARRANQUE	K1	3,83 ¢
MA97-07	ARRANQUE COMPLETO=BA4C15	K2	8,72 ¢
MA97-08	INTERRUPTOR APAGADO	K13	1,50 ¢
MA97-09	VARILLA ACELERADOR	L2	0,28 ¢
MA97-10	MUELLE RETORNO ACELERADOR	L5	0,22 ¢
MA97-11	MUELLE REGULADOR	L4	0,22 ¢
MA97-12	VENTILADOR REFRIGERACION	F1	2,38 ¢
MA97-13	BOBINA	H3	7,55 ¢
MA97-14	TAPA FILTRO AIRE	G1	1,88 ¢
MA97-15	CULATA MOTOR IC-100	G2	4,22 ¢
MA97-16	VOLANTE MOTOR	F3	24,58 ¢
MA97-17	TAPÓN CALA ACEITE	B7	1,12 ¢
MA97-18	JUNTA CULATA	E1	1,50 ¢
MA97-19	VALVULA ADMISIÓN	C5	2,45 ¢
MA97-20	VALVULA ESCAPE	C4	2,45 ¢
MA97-21	ESCAPE	J2	4,00 ¢
MA97-22	VASO DE ARRANQUE	F2	1,50 ¢
MA97-23	PISTON	D8	9,83 ¢
MA97-24	BULON	D9	0,67 ¢
MA97-25	PRESILLAS	D10	0,30 ¢
MA97-26	AROS	D11	3,33 ¢
MA97-27	JUNTA CARTER MOTOR MA97	B2	1,17 ¢
MA97-28	JUNTA ESCAPE MA97	J1	0,33 ¢
MA97-29	CIGÜEÑAL	D10	31,33 ¢
MA97-30	BIELA=ba4c15	D4	4,80 ¢
MA97-31	JUNTA BRIDA - CILINDRO MA97	M1	0,17 ¢
MA97-32	BRIDA MA97	M3	0,88 ¢
MA97-33	JUNTA BRIDA - CARBURADOR MA97	M4	0,17 ¢
MA97-34	RETEN CIGÜEÑAL MA97	B6	1,00 ¢
MA97-35	RETEN VALVULA MA97	C6	1,00 ¢
MA97-36	ARANDELA ACOPLE VALVULA ADMS. MA97	C7	1,00 ¢
MA97-37	REGULADOR	B13	1,83 ¢